



Land Surveyors/Engineers

# Gustin, Cothorn & Tucker, Inc.

121 Hart Street  
Niceville, FL 32578

Telephone  
(850) 678-5141

April 11, 2001

Mr. Steve Andrews  
Department of Environmental Protection  
160 Government Center  
Pensacola, Florida 32501-5794  
850-595-8300 ext 1124  
850-595-8311 Fax

RE: Swift Creek Park  
Job # 46-0070659-002

Dear Mr. Andrews,

Gustin, Cothorn & Tucker representing Ruckel Properties hereby request to remove the application for a joint use permit for the above referenced project. After lengthy consideration we feel that reducing the scope of work to the uplands areas and replacement of the existing pipe to its original condition will maintain the on-going natural rehabilitation of the created wetlands.

If you have any questions regarding this matter, please contact me at 850-678-5141.

Sincerely,

Allen E. Tucker, P.S.  
Vice-President

AET:db

cc: Walt Ruckel

RECEIVED  
APR 12 2001  
NORTHWEST FLORIDA  
DEP



# GUSTIN, COTHERN & TUCKER, INC.

LAND SURVEYORS/ENGINEERS

121 Hart Street  
Niceville, Florida 32578

☎ Phone (850) 678-5141

☒ Fax (850) 729-2460

February 22, 2001

Mr. Steve Andrews  
Department of Environmental Protection  
160 Governmental Center  
Pensacola, FL 32501-5794  
850-595-8300 ext. 1124  
850-595-8311 FAX

RE: Swift Creek Park  
Job # 46-0070659-002

Dear Mr. Andrews;

Gustin, Cothern & Tucker representing Ruckel Properties hereby request a waiver on the deadline for action concerning this project. We request an additional 90 days to revise our permit.

If you have any questions regarding this matter, please contact me at 850-678-5141

Sincerely,

Allen E. Tucker, P.S.  
Vice President

cc: Walt Ruckel

RECEIVED  
FEB 23 2001  
NORTHWEST FLORIDA  
DEP.

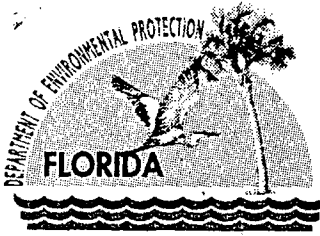

# Department of Environmental Protection

Jeb Bush  
Governor

Northwest District  
160 Governmental Center  
Pensacola, Florida 32501-5794

David B. Struhs  
Secretary

WAIVER OF 90 DAY TIME LIMIT  
UNDER SECTIONS 120.60(2) AND 403.0876 FLORIDA STATUTES

Permit Application Number: 46-0070659-002 DF

Applicant's Name: Ruckel Properties, INC

With regard to the above referenced application, the applicant hereby with full knowledge and understanding of applicant's rights under Sections 120.60(2) and 403.0876, Florida Statutes, waives the right to have the application approved or denied by the State of Florida Department of Environmental Protection within the 90 day time period prescribed by law. Said waiver is made freely and voluntarily by the applicant, with full knowledge, and without any pressure or coercion by anyone employed by the State of Florida Department of Environmental Protection.

\* This waiver shall expire on the \_\_\_\_\_ day of \_\_\_\_\_, 2000.

The undersigned is authorized to make this waiver on behalf of the applicant.

\*   
Signature

JAMES P. RUCKEL  
Name (Please Print or Type)



# GUSTIN, COTHERN, & TUCKER, INC.

LAND SURVEYORS/ENGINEERS

121 Hart Street

Niceville, Florida 32578

☎ Phone (850) 678-5141

☎ Fax (850) 729-2460

13 November 2000

Ms. Patti Salvaggio  
Florida Department of Environmental Protection  
Northwest District  
160 Governmental Center  
Pensacola, FL 32501

Re: File No.: 46-0070659-002-DF

Dear Ms. Salvaggio;

We recently met with the U.S. Fish and Wildlife Service concerning this project. This requirement is due to the presence of the Okaloosa Darta's in the Shaw Still Branch which runs along the eastern and southern boundaries of this project. The U.S. FWS representative suggested some modifications in our permit due to the existing conditions at the project site.

These requested changes would greatly reduce the dredge and fill activities in the projects existing wetlands and would basically serve the communities need for a park. We took these ideas back to Ruckel Properties who agreed to revise the overall scope of work.

With that being considered, we hereby request an extension for this project in order to revise our application. We hope this revision will satisfy U.S. FWS concerns. We expect to have the revisions complete within 90 days.

If you have any questions, please call me.

Sincerely,

Allen E. Tucker, P.S.  
Vice President

Done.

Extended to 24 Feb  
2001

cc: Doug Gilmore                      B.R.A.  
      Don Hambrich                    US ACOE  
      Walt Ruckel                      Ruckel Properties

RECEIVED

NOV 14 2000

Northwest Florida  
DEP

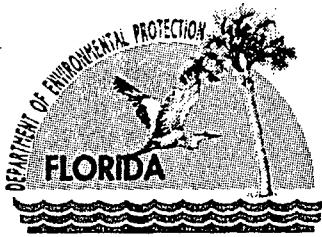

Jeb Bush  
Governor

# Department of Environmental Protection

Northwest District  
160 Governmental Center  
Pensacola, Florida 32501-5794

David B. Struhs  
Secretary

October 11, 2000

Mr. John Gustin  
121 Hart Street  
Niceville, FL. 32578

File No.: 46-0070659-002-DF  
Applicant: Ruckel Properties

Dear Mr. Gustin,

This letter serves as a summary of the status of the Ruckel project. As of September 27, 2000, this project was deemed complete and needs only the mitigation plan submitted in order for permit to be processed. Per our meeting in September, the mitigation should involve a conservation easement over approximately 30 acres within the Swift Creek development. The time clock for issuance or denial of the permit expires on November 26, 2000. If at that time you have not submitted the required mitigation, the project may be recommended for denial. Alternatively, you may request a waiver of the time clock for up to 90 days in order to submit the information needed. That waiver is enclosed.

If I can be of any further assistance, please contact me at 850-595-8300 x1127.

Sincerely,

Patti Salvaggio  
Submerged Lands & Environmental  
Resources Program



# GUSTIN, COTHERN, & TUCKER, INC.

LAND SURVEYORS/ENGINEERS

121 Hart Street

Niceville, Florida 32578

☎ Phone (850) 678-5141

☎ Fax (850) 729-2460

24 August 2000

Ms. Patti Salvaggio  
Submerged Lands & Environmental  
Department of Environmental Protection  
Northwest District  
160 Governmental Center  
Pensacola, FL 32501

Re: Ruckel Properties, Inc.  
File: 46-0070659-002

Dear Ms. Salvaggio;

Please find the following additional information as requested:

- ✓ 1. Please provide an 8½ x 11 plan view that shows the location of the three cross sections.  
*See revised submittal.*
2. On the cross sections, indicate the ordinary high water line.  
*See revised submittal.*
- ✓ 3. On the plan view indicate the DEP wetland jurisdiction line.  
*See revised submittal.*
- ok 4. Please clarify if the proposed littoral shelves are proposed as off-setting mitigation for the impacts.  
*Will be provided separately.*
- ✓ 5. Please provide a stormwater plan or indicate if you intend to apply for this separately.  
*Will be provided separately.*
- ✓ 6. What are the small squares around the cul-de-sac as indicated on the plan view?  
*Grassed parking spaces.*
- ✓ 7. What is the structure located in the circular area on the south west side of the project? Has that been included in the estimate of impacts?  
*Gazebo, yes.*
- ✓ 8. Describe the purpose of the playing field, how it will be surfaced and how the slopes will be stabilized?  
*The playing field will be used by Swift Creek subdivision residences for soccer and tag football. The field will be solid sodded and the slopes will be at a 10:1 ratio to minimize erosion.*

dredge = 0.2

9. It appears that you are proposing to dredge the lakes to -5 feet. Please indicate the method for dredging and the location and manner of disposal of the dredge material. Provide a spoil disposal detail, including discharge details, locations, retention plans, volumes, and data used to size the disposal cell(s).

*The existing lakes will be drained by pumping clear lakewater into the existing 24" pipe outfall. A six inch under drain will then be installed at a depth of 5' below lowest grade within the lakebeds. The filtered groundwater will be pumped to outfall. A backhoe will be used to excavate and shape the lakebeds. The excavated material which is all clean sand will be used to fill the area of the proposed play field. All slopes above waterline will be immediately stabilized by sodding after construction. The project will be completed within a 30 day period.*

✓ 10. You indicate that the ground water shall be piped to an existing retention pond. Records appear to indicate that the retention pond was part of the stormwater plan for Swift Creek Phase I and therefore, groundwater may not be pumped into this pond. Please address this issue including the volume of groundwater that is involved. Note: you may need a consumptive use permit from the Northwest Florida Water Management District.

*Will not use retention basins.*

✓ 11. If demucking is proposed, provide the estimated cubic yardage and location of the storage or disposal site of the muck, and whether or not the muck will be used as slope dressing.

*There is no muck.*

✓ 12. Provide fully dimensioned or scaled cross section views of typical roadway sections and work proposed at culvert locations. One or two typical sections may be sufficient where roadway sections remain relatively consistent. Where topographic, roadway, or other features change additional cross sectional views will be required to adequately reflect changes in existing and proposed conditions.

*See revised submittal.*

? → 13. Provide in detail the methods and equipment which are proposed to be employed in accomplishing the proposed project. If known, indicate the timing and staging of the project. Include all anticipated methods and materials which will be employed to stabilize slopes and protect adjacent waters from erosion of sediments and other harmful materials from the work site.

*Included in Item 9.*

14. If dewatering will be required, provide complete details of temporary dikes, discharge locations, time periods, and methods for preventing turbid discharges.

*Included in Item 9.*

If you need any further assistance, please call me.

Sincerely,

  
John C. Gustin, III



# Florida Department of Environmental Regulation

Twin Towers Office Bldg. • 2600 Blair Stone Road • Tallahassee, Florida 32399-2400

DER Form #	17-312.900(1)
Form Title	Joint App. for Works in the Waters of Florida
Effective Date	October 30, 1991
DER Application No.	(Filled in by DER)

## Joint Application for Works in the Waters of Florida

Department of the Army (Corps)/Florida Department of Environmental Regulation (DER)  
Department of Natural Resources (DNR)/Delegated Water Management District (Delegated WMD)

Type or Print Legibly

Corps Application Number (official use only)	DER Application Number (official use only)	
<b>1. Applicant's Name and Address</b>		
Name <u>Ruckel Properties, Inc.</u> <small>Last Name, First name (if individual); Corporate Name; Name of Govt. Agency</small>		
Street <u>17 John Sims Parkway</u>		
City <u>Niceville,</u>	State <u>Florida</u> Zip <u>32580</u>	
Telephone ( <u>850</u> ) <u>678-2224</u> (Day) ( ) (Night)		
<b>2. Name, Address, Zip Code, Telephone Number and Title of Applicant's Authorized Agent</b>		
Name <u>John C. Gustin III - Project Manager</u> <small>Last Name, First Name</small>		
Corporate Name; Name of Govt. Agency <u>Gustin, Cothorn, &amp; Tucker, Inc.</u>		
Street <u>121 Hart Street</u>		
City <u>Niceville</u>	State <u>Florida</u> Zip <u>32578</u>	
Telephone ( <u>850</u> ) <u>678-5141</u> (Day) ( ) (Night)		
<b>3. Name of Waterway at Work Site:</b> <u>Still Branch</u>		
<b>4. Street, Road or Other Location of Work</b> <u>Southeast corner of College Boulevard &amp; existing dirt road</u>		
Incorporated City or Town _____		
Section <u>4</u>	Township <u>1 South</u> Range <u>22 West</u>	
Section _____	Township _____ Range _____	
Section _____	Township _____ Range _____	
County(ies) _____		
Coordinates in Center of Project:		
Latitude <u>30</u> ° <u>32</u> ' <u>9</u> "	Federal Projects Only: _____ x _____ y	
Longitude <u>86</u> ° <u>27</u> ' <u>20</u> "		
Lot _____ Block _____ Subd _____ Plat Bk _____ Pg _____		
Directions to Locate Site: <u>Take State Road 285 from I-10 to College Boulevard. The project is located on the southeast corner of College Boulevard and existing dirt road approximately about 1/3 of a mile from the intersection of S.R. 285 and College Boulevard.</u>		
<b>5. Names, Addresses, and Zip Codes of Adjacent Property Owners Whose Property Also Adjoins the Water (Excluding Applicant). Show Numbers or Names of These Owners on Plan Views. If More Than Six (6) Owners Adjoin the Project, You May Be Required to Publish a Public Notice for the DER.</b>		
1. <u>Ruckel Properties, Inc.</u> <u>P.O. Box 187</u> <u>Valparaiso, Fl. 32580</u>	2. <u>Andrew &amp; Elizabeth Beno</u> <u>1023 Christy Drive</u> <u>Niceville, Fl. 32578</u>	3. <u>Lawrence Earl Campbell, Jr.</u> <u>805 Sparleberry CV</u> <u>Niceville, Fl. 32578</u>
4. <u>Jefferson &amp; Gaylin Severs</u> <u>1096 Forest Lake Tr</u> <u>Niceville, Fl 32576</u>	5. <u>John H. Kirnin</u> <u>6112 Lapreniere Street</u> <u>St. Metairie, La 70003</u>	6. <u>Danny &amp; Amy Jones</u> <u>4406 South Minster Circle</u> <u>Niceville, Fl 32578</u>



ADJACENT PROPERTY OWNERS  
CONTINUATION

- 7) Mark A. & Jeanne M. Mello  
527 Matthew Street  
Niceville, Florida 32578
- 8) John T. & Shelby B. Dubose  
2398 Chase Drive  
Niceville, Florida 32578
- 9) William & Terri Markowski  
2196 Chase Drive  
Niceville, Florida 32578
- 10) John S. & Nita Jordan, III  
2194 Chase Drive  
Niceville, Florida 32578
- 11) Earl S. & Gail S. Paris  
2192 Chase Drive  
Niceville, Florida 32578
- 12) Lucille E. Schaefer  
c/o Trust Company of Oklahoma  
P.O. Box 3627  
Tulsa, OK 74101
- 13) Bruce C. & Susan J. Shepard  
2184 Chase Drive  
Niceville, Florida 32578
- 14) Henry & Carol Zmuda  
2182 Chase Drive  
Niceville, Florida 32578
- 15) Timothy & Cristy Perry  
2180 Chase Drive  
Niceville, Florida 32578
- 16) William T. Gaskell, Jr.  
2178 Chase Drive  
Niceville, Florida 32578

6. Proposed Use (Check one or more as applicable) Private Single Family  Multi Family   
 Public  Commercial  New Work  Alteration of Existing Works  Maintenance  Other (Explain) Park

7. Desired Permit Duration (see Fee Schedule)  
 5 Yr  10 Yr  Other (Specify) \_\_\_\_\_

8. General Permit or Exemption Requested  
 DER General Permit FAC Rule 17-312. X DER Exemption FAC Rule 17-312. \_\_\_\_\_ Section 403. \_\_\_\_\_ F.S.

9. Total Extent of Work in Jurisdictional Open Waters or Wetlands: (Use additional sheets and provide complete breakdown of each category if more space is needed.)

a. Within Corps Jurisdiction:					
Fill:	<u>119,030</u>	Sq. Ft.	<u>2.733</u>	Acres	<u>16,905</u> Cu. Yds.
Excavation:	<u>9,048</u>	Sq. Ft.	<u>0.208</u>	Acres	<u>18,493</u> Cu. Yds.
b. Within DER Jurisdiction:					
Fill:	<u>119,030</u>	Sq. Ft.	<u>2.733</u>	Acres	<u>16,905</u> Cu. Yds.
Excavation:	<u>9,048</u>	Sq. Ft.	<u>0.208</u>	Acres	<u>18,493</u> Cu. Yds.
Excavation Waterward of MHW _____ cu. yds. (Information needed for DNR)					

c. DER Jurisdictional Area Severed (Area Landward of Fill Structures which will be Severed):  
 \_\_\_\_\_ Sq. Ft. \_\_\_\_\_ Acres

d. DER Jurisdictional Area Created (New Excavation from Uplands, Exclusive of Mitigation):  
 \_\_\_\_\_ Sq. Ft. \_\_\_\_\_ Acres

e. Docks, Piers, and Over Water Structures:  
 Total Number of Slips \_\_\_\_\_ Total Number of Mooring Pilings \_\_\_\_\_  
 Length \_\_\_\_\_ Width \_\_\_\_\_ Height above MHW \_\_\_\_\_  
 Length \_\_\_\_\_ Width \_\_\_\_\_ Height above MHW \_\_\_\_\_  
 Number of Finger Piers \_\_\_\_\_ Length \_\_\_\_\_ Width \_\_\_\_\_ Height \_\_\_\_\_  
 Number of Finger Piers \_\_\_\_\_ Length \_\_\_\_\_ Width \_\_\_\_\_ Height \_\_\_\_\_  
 Total area of structure over waters & wetlands \_\_\_\_\_ sq. ft.  
 Use of structure \_\_\_\_\_

Will the docking facility provide:	No	Yes	Number
Liveboard Slips	<input type="checkbox"/>	<input type="checkbox"/>	_____
Fueling Facilities	<input type="checkbox"/>	<input type="checkbox"/>	_____
Sewage Pump-out Facilities	<input type="checkbox"/>	<input type="checkbox"/>	_____
Other Supplies or Services Required for Boating (Excluding refreshments, bait and tackle)	<input type="checkbox"/>	<input type="checkbox"/>	_____

f. Seawall length \_\_\_\_\_ ft. Seawall material \_\_\_\_\_  
 Riprap revetment length \_\_\_\_\_ ft. Slope \_\_\_\_\_ H: \_\_\_\_\_ V \_\_\_\_\_ Toe width \_\_\_\_\_ ft.  
 Riprap at toe of seawall length \_\_\_\_\_ ft. Slope \_\_\_\_\_ H: \_\_\_\_\_ V \_\_\_\_\_ Toe width \_\_\_\_\_ ft.  
 Size of riprap \_\_\_\_\_  
 Type of riprap or seawall material \_\_\_\_\_

g. Other (See Item 10). \_\_\_\_\_

10. Description of Work (be specific; use additional sheets as necessary).  
 Consists of dredging and filling 2.941 acres. To reshape lakes, 1.15 acres of littoral shelves will be created with wetland plantings in these areas.

11. Turbidity, Erosion, and Sedimentation Controls Proposed:  
 During construction, an underdrain system will be installed five (5) feet below the lowest elevation of lakebed. Only filtered groundwater will be released into Shaw Still Branch. Silt fences will be installed along any areas of disturbance which could lead to soil being deposited into wetlands. Any areas of disturbance will be sodded immediately after construction.

12. Date Activity is Proposed to Commence Upon approval ; to be Completed \_\_\_\_\_  
 Total Time Required to Construct \_\_\_\_\_

13. Previous Applications for this Project have been: N/A                      DER No.                      Corps No.  
 A. Denied (date) \_\_\_\_\_  
 B. Issued (date) \_\_\_\_\_  
 C. Other (please explain) \_\_\_\_\_  
 Differentiate between existing work and proposed work on the drawings.

14. Certification. Application is hereby made for a permit or permits to authorize the activities described herein.

A. I Certify That: (Please check appropriate space)

1. I am the record owner  ; lessee  , or the record easement holder  of the property on which the proposed project is to be undertaken, as described in the attached legal document.

2. I am not  the record owner, lessee, or record easement holder of the property on which the proposed project is to be undertaken, as described in the attached legal document, but I will have, before undertaking the proposed work, the requisite property interest. (Please explain what the interest will be and how it will be acquired.)

**Attach legal description of property or copy of deed to the property on which project is to occur (must be provided)**

B. I understand I may have to provide any additional information/data that may be necessary to provide reasonable assurance or evidence that the proposed project will comply with the applicable State Water Quality Standards or other environmental standards both before construction and after the project is completed.

C. In addition, I agree to provide entry to the project site for inspectors with proper identification or documents as required by law from the environmental agencies for the purpose of inspecting the site. Further, I agree to provide entry to the project site for such inspectors to monitor permitted work, if a permit is granted.

D. This is a Joint Application and is not a Joint Permit. I hereby acknowledge the obligation and responsibility for obtaining all of the required state, federal or local permits before commencement of construction. I also understand that before commencement of this proposed project, I must be granted separate permits or authorizations from the U.S. Corps of Engineers, the U.S. Coast Guard, the Department of Environmental Regulation, the Delegated Water Management District (where applicable), and the Department of Natural Resources, as necessary.

E. I am familiar with the information contained in this application, and that to the best of my knowledge and belief, such information is true, complete and accurate. I further certify that I possess the authority to undertake the proposed activities or am acting as the duly authorized agent of the applicant. I understand that knowingly making any false statement or representation in this application is a violation of Section 403.161, F.S. and Chapter 837, F.S.

John C. Gustin, III

Typed/Printed Name of Applicant or Agent

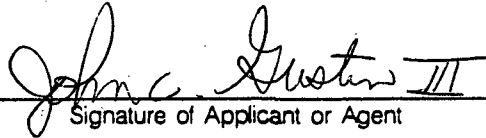

Signature of Applicant or Agent

8-28-00

Date

Project Manager

(Corporate Title if applicable)

AN AGENT MAY SIGN ABOVE IF APPLICANT COMPLETES THE FOLLOWING:

I hereby designate and authorize the agent listed above to act on my behalf as my agent in the processing of this permit application and to furnish on request, supplemental information in support of the application.

James R. Ruckel

Typed/Printed Name of Applicant



Signature of Applicant

8-28-00

Date

Development Manager

(Corporate Title if applicable)

15. **For your information:** Section 370.034, Florida Statutes, requires that all dredge and fill equipment owned, used, leased, rented or operated in the state shall be registered with the Department of Natural Resources. Before selecting your contractor or equipment you may wish to determine if this requirement has been met. For further information, contact the Chief of the Bureau of Saltwater Licenses and Permits, Department of Natural Resources, 3900 Commonwealth Boulevard, Tallahassee, Florida 32399. Telephone No. (904) 487-3122. **This is not a requirement for a permit from the Department of Environmental Regulation.**

18 U.S.C. Section 1001 provides that, Whoever, in any manner within the jurisdiction of any department or agency of The United States knowingly and willfully falsifies, conceals, or covers up by any trick, scheme, or device a material fact or makes any false, fictitious or fraudulent statements or representations or makes or uses any false writing or document knowing same to contain any false, fictitious or fraudulent statement or entry, shall be fined not more than \$10,000 or imprisoned not more than five years, or both.

16. Please submit this completed form, with attached drawings and the complete DER processing fee (see Fee Schedule in Rule 17-4.050, F.A.C., copy attached) to the appropriate DER or Delegated WMD office with jurisdiction over the project site.

**SHEET NO.**

**DESCRIPTION**

1	VICINITY MAP
2	LEGAL DESCRIPTION
3	SITE PLAN
4	GRADING PLAN
5	TYPICAL SECTIONS
6	DREDGE & FILL PLAN
7	PLANTING SCHEDULE
8	SECTION A-A PLAN VIEW
9	SECTION A-A PROFILE
10	SECTION B-B PLAN VIEW
11	SECTION B-B PROFILE
12	SECTION C-C PLAN VIEW
13	SECTION C-C PROFILE
14	EROSION CONTROL DETAIL

A circular professional seal for James L. Santos, a Professional Engineer in the State of Massachusetts. The seal contains the text: "JAMES L. SANTOS", "STATE OF MASSACHUSETTS", "CERTIFIED PROFESSIONAL ENGINEER", "No. 35557", and "DATE 8/28/03". A handwritten signature, "James L. Santos", is written across the seal.

**PROJECT LOCATION**

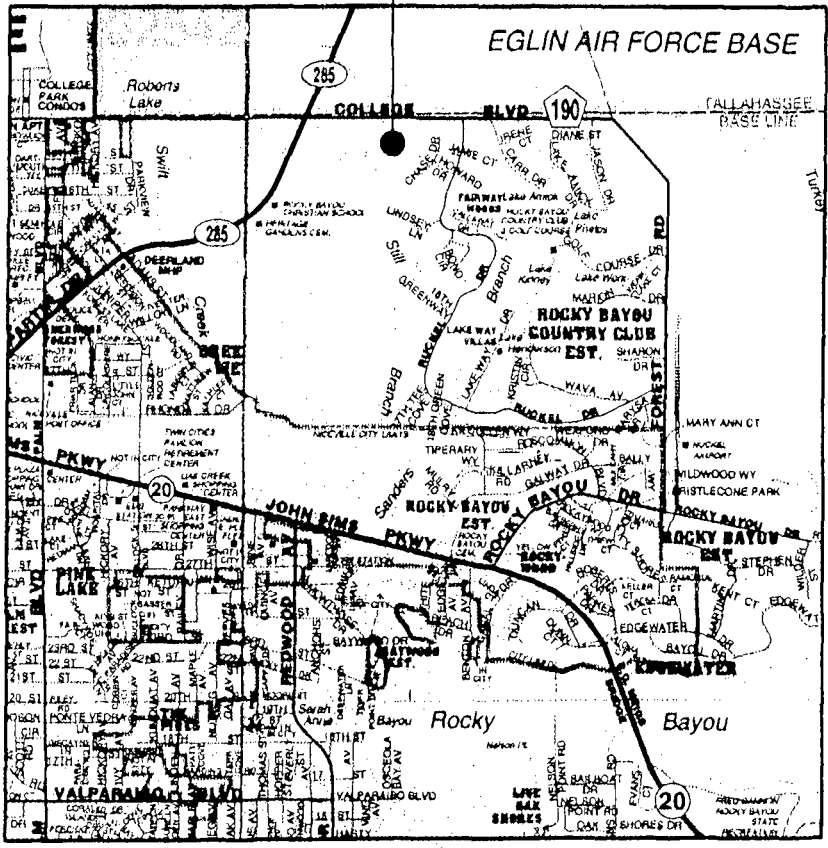

**VICINITY MAP**

LATITUDE: 30°32'00"  
 LONGITUDE: 86°27'17"  
 SECTION 4  
 TOWNSHIP 1 SOUTH  
 RANGE 22 WEST

James L. Burt  
 CERTIFICATE  
 No. 25301  
 STATE OF FLORIDA  
*James L. Burt*  
 8/28/00

Applicant: RUCKEL PROPERTIES, INC.  
 County: OKALOOSA  
 Datum: N.G.V.D.  
 Adjacent Property Owner's: SEE SHEET  
 Water Body: STILL BRANCH

Purpose: CONSTRUCTION OF SITE IMPROVEMENTS  
 RELATED TO NEW PARK.  
 Original Work  Maintenance   
 Sheet No. 1 of 14  
 Date: May 9, 2000 Revised: August 7, 2000

## LEGAL DESCRIPTION:

A PARCEL OF LAND LYING IN SECTION 4, TOWNSHIP 1 SOUTH, RANGE 22 WEST, OKALOOSA COUNTY, FLORIDA, AND BEING MORE PARTICULARLY DESCRIBED AS FOLLOWS:

COMMENCE AT THE NORTHERNMOST CORNER OF LOT 1, SWIFT CREEK PHASE II, A RESIDENTIAL SUBDIVISION RECORDED IN PLAT BOOK 18, PAGE 74 OF THE PUBLIC RECORDS OF OKALOOSA COUNTY, FLORIDA; SAID POINT ALSO BEING ON THE EASTERLY BOUNDARY LINE OF RETENTION AREA NO. 1 OF SWIFT CREEK PHASE I, A RESIDENTIAL SUBDIVISION RECORDED IN PLAT BOOK 18, PAGE 47 OF THE PUBLIC RECORDS OF SAID COUNTY; THENCE ALONG THE EASTERLY BOUNDARY LINE OF SAID RETENTION AREA N59°11'32"E 18.20 FEET; THENCE N16°49'55"W 64.32 FEET TO THE POINT OF BEGINNING; THENCE CONTINUE ALONG SAID RETENTION AREA BOUNDARY LINE N16°49'55"W 41.79 FEET; THENCE S90°00'00"W 153.44 FEET TO A POINT ON THE CURVED NORTHEASTERLY RIGHT-OF-WAY OF WINDING WATERS WAY (60' R/W) AS SHOWN ON THE AFOREMENTIONED PLAT OF SWIFT CREEK PHASE I; THENCE NORTHWESTERLY ALONG SAID CURVE BEING CONCAVE TO THE SOUTHWEST AND HAVING A RADIUS OF 330.00 FEET, THROUGH A CENTRAL ANGLE OF 22°20'03" AN ARC DISTANCE OF 128.64 FEET (CHORD = 127.82 FEET; CHORD BEARING = N37°09'27"W) TO A POINT; THENCE, DEPARTING SAID RIGHT-OF-WAY LINE, RUN N41°40'32"E 22.35 FEET; THENCE N85°12'30"E 115.09 FEET; THENCE N04°47'30"W 629.13 FEET; THENCE N01°43'55"E 147.34 FEET TO A POINT ON THE SOUTHERLY RIGHT-OF-WAY LINE OF COLLEGE BOULEVARD (100' R/W); THENCE ALONG SAID RIGHT-OF-WAY LINE S88°16'05"E 924.13 FEET; THENCE, DEPARTING COLLEGE BOULEVARD RUN S01°43'55"W 452.16 FEET; THENCE S62°48'34"W 136.80 FEET; THENCE S90°00'00"W 138.36 FEET; THENCE S34°13'53"W 483.81 FEET; THENCE S90°00'00"W 216.54 FEET TO THE POINT OF BEGINNING.

PARCEL CONTAINS 15.42 ACRES, MORE OR LESS.



Applicant: RUCKEL PROPERTIES, INC.  
County: OKALOOSA  
Datum: N.G.V.D.  
Adjacent Property Owner's: SEE SHEET  
Water Body: STILL BRANCH

Purpose: CONSTRUCTION OF SITE IMPROVEMENTS  
RELATED TO NEW PARK.

Original Work  Maintenance

Sheet No. 2 of 14

Date: May 9, 2000

Revised: August 7, 2000

# LITTORAL SHELF

AREA (S.F.)	ACREAGE
50,088	1.150

COLLEGE BLVD.

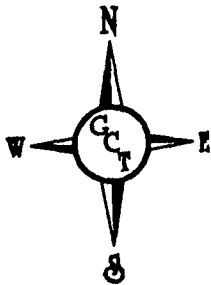

SCALE: 1" = 200'

FUTURE COMMERCIAL DEVELOPMENT  
(VACANT & WOODED)

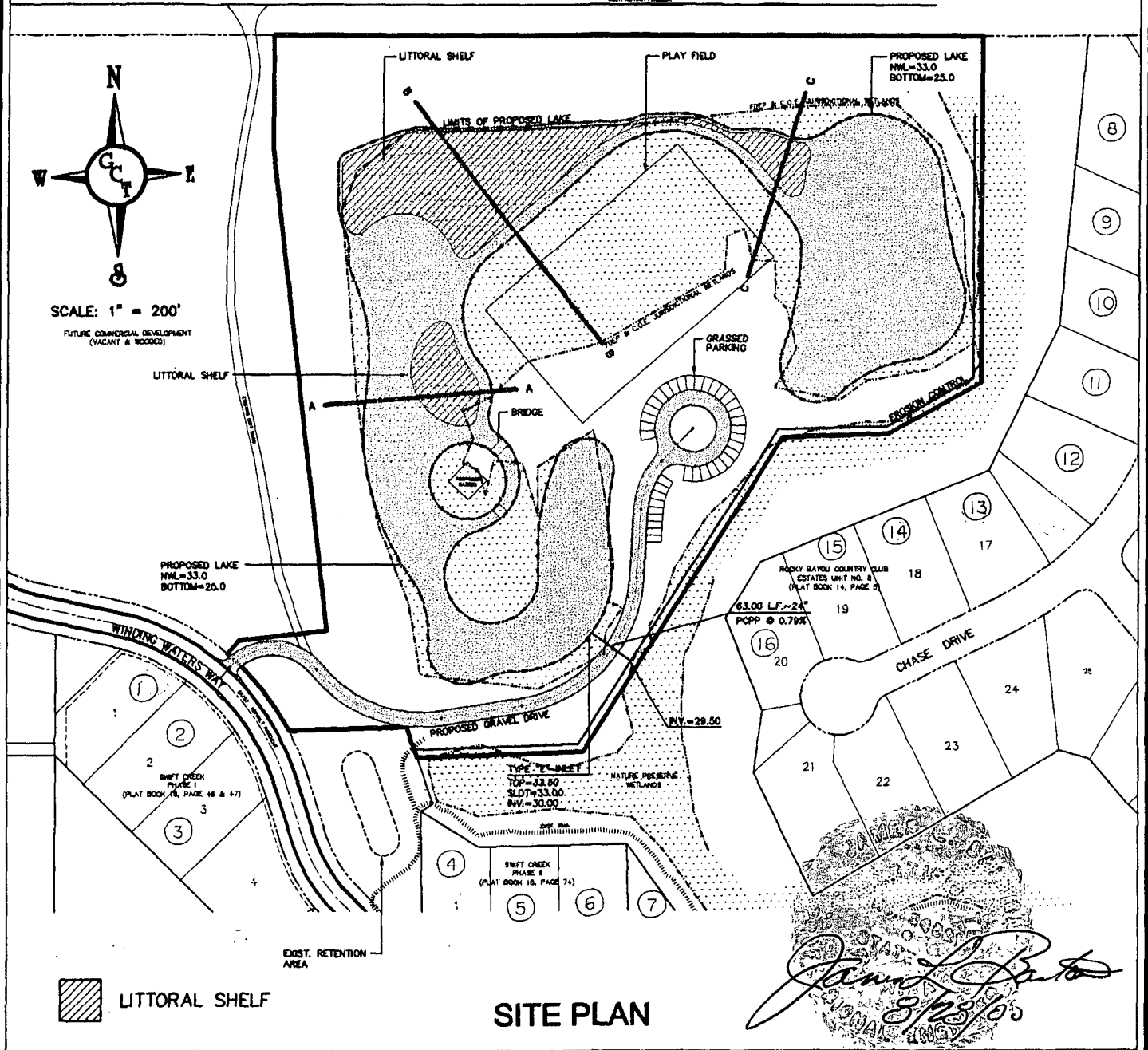

 LITTORAL SHELF

## SITE PLAN

Applicant: RUCKEL PROPERTIES, INC.  
 County: OKALOOSA  
 Datum: N.G.V.D.  
 Adjacent Property Owner's: SEE SHEET  
 Water Body: STILL BRANCH

Purpose: CONSTRUCTION OF SITE IMPROVEMENTS  
 RELATED TO NEW PARK.  
 Original Work  Maintenance   
 Sheet No. 3 of 14  
 Date: May 9, 2000 Revised: August 7, 2000



F.D.E.P. AND C.O.E.  
JURISDICTIONAL  
WETLAND LINE

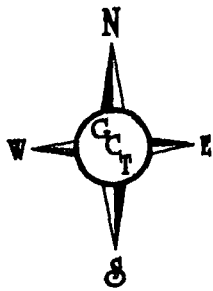

SCALE: 1" = 200'

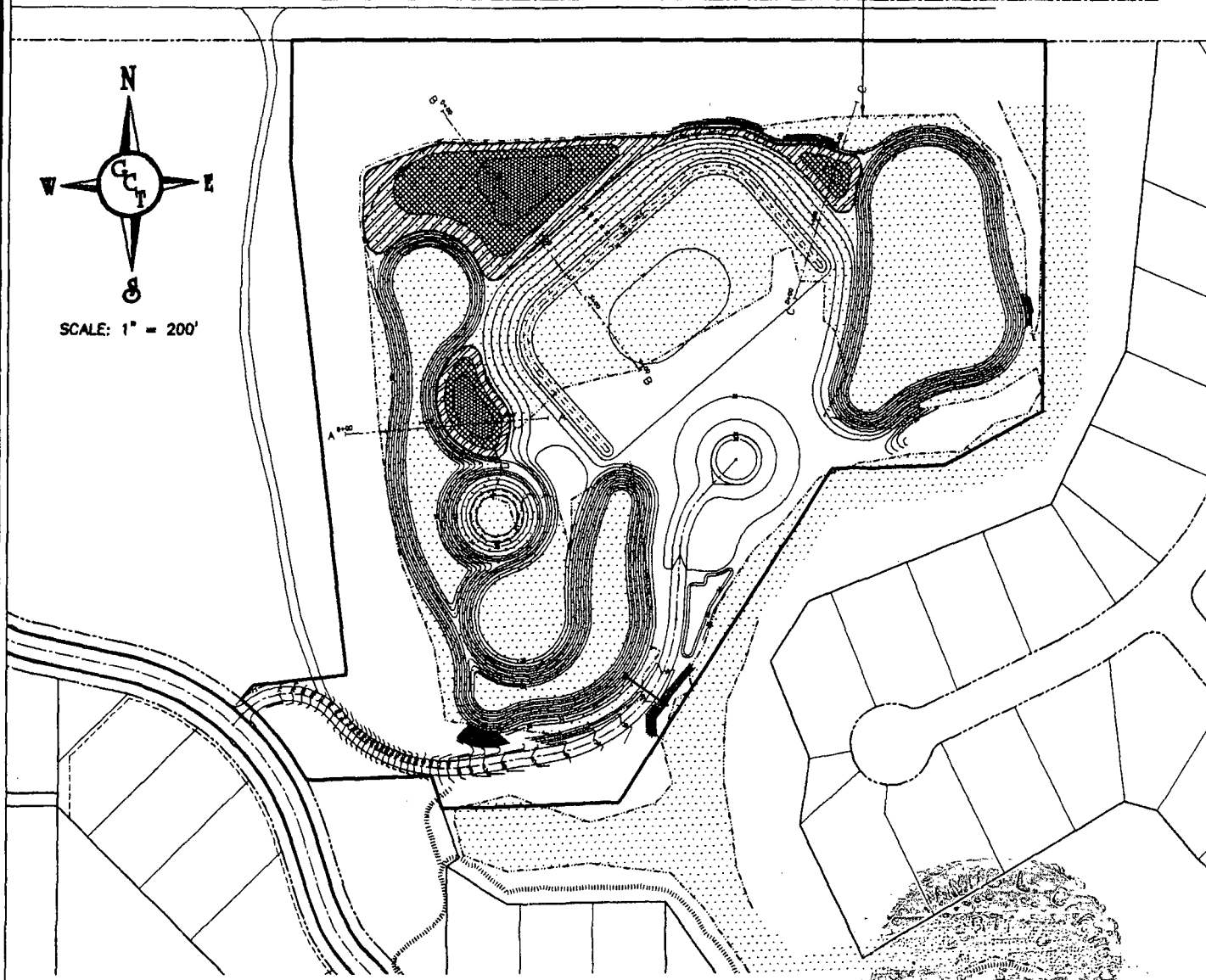

### GRADING PLAN

*Janet L. Patten*  
8/23/00

Applicant: RUCKEL PROPERTIES, INC.  
County: OKALOOSA  
Datum: N.G.V.D.  
Adjacent Property Owner's: SEE SHEET  
Water Body: STILL BRANCH

Purpose: CONSTRUCTION OF SITE IMPROVEMENTS  
RELATED TO NEW PARK.  
Original Work  Maintenance   
Sheet No. 4 of 14  
Date: May 9, 2000 Revised: August 7, 2000

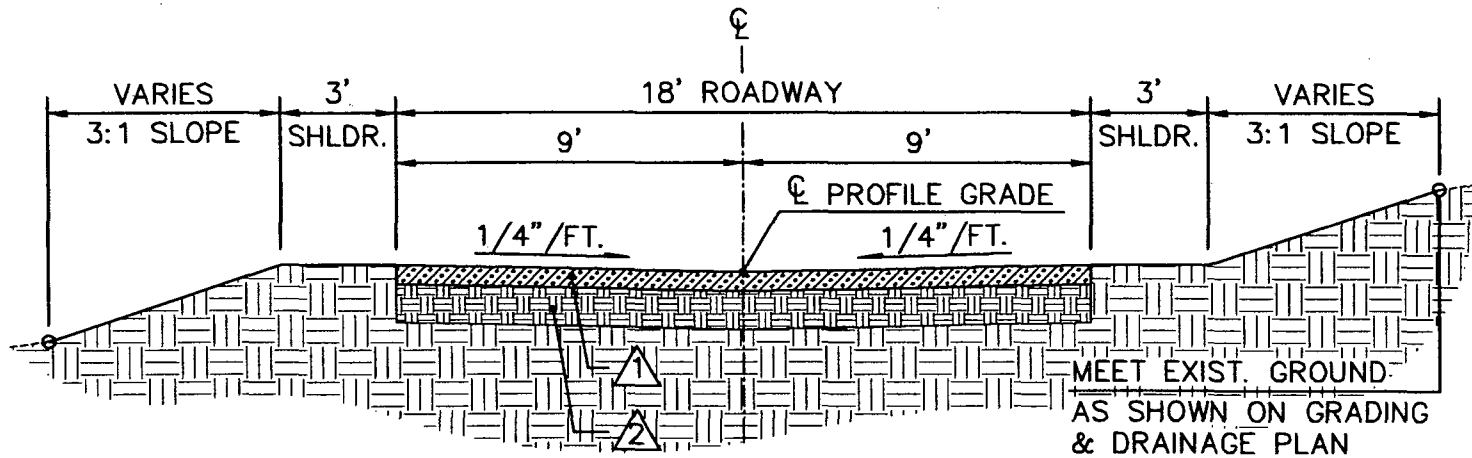

## TYPICAL ROADWAY SECTION

SCALE: 1" = 5'-0"

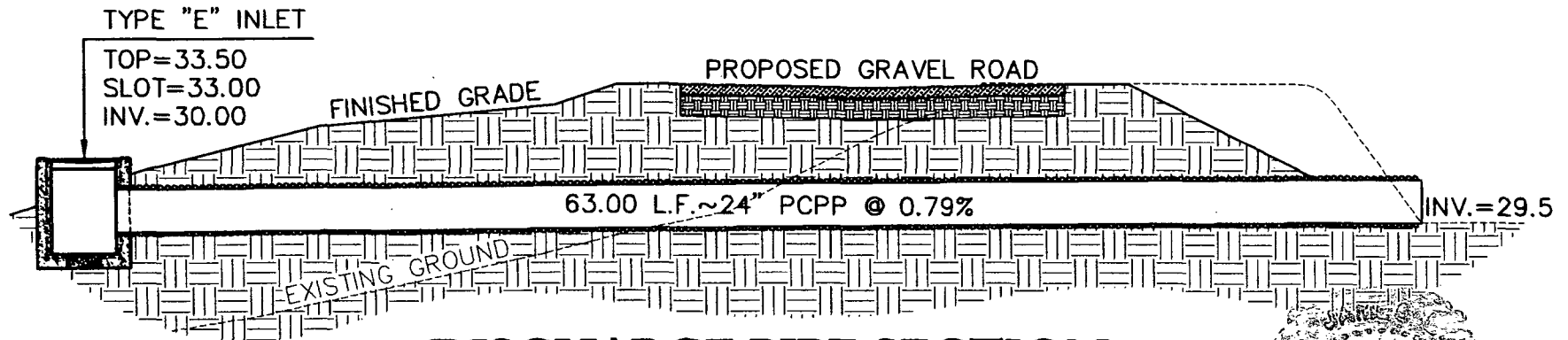

## DISCHARGE PIPE SECTION

SCALE: 1" = 8'-0"

### TYPICAL SECTIONS

*James L. Pastor*  
8/22/00

Applicant: RUCKEL PROPERTIES, INC.  
 County: OKALOOSA  
 Datum: N.G.V.D.  
 Adjacent Property Owner's: SEE SHEET  
 Water Body: STILL BRANCH

Purpose: CONSTRUCTION OF SITE IMPROVEMENTS  
 RELATED TO NEW PARK.  
 Original Work  Maintenance   
 Sheet No. 5 of 14  
 Date: May 9, 2000 Revised: August 7, 2000

**DREDGE & FILL TABLE**

	AREA (S.F.)	ACREAGE	VOL. (C.Y.)
DREDGE	±9,048	±0.208	18,493
FILL	±119,030	±2.733	16,905

COLLEGE BLVD.

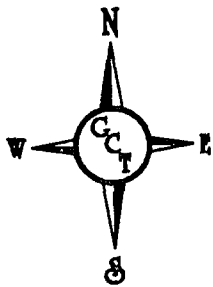

SCALE: 1" = 200'

FUTURE COMMERCIAL DEVELOPMENT  
(VACANT & WOODED)

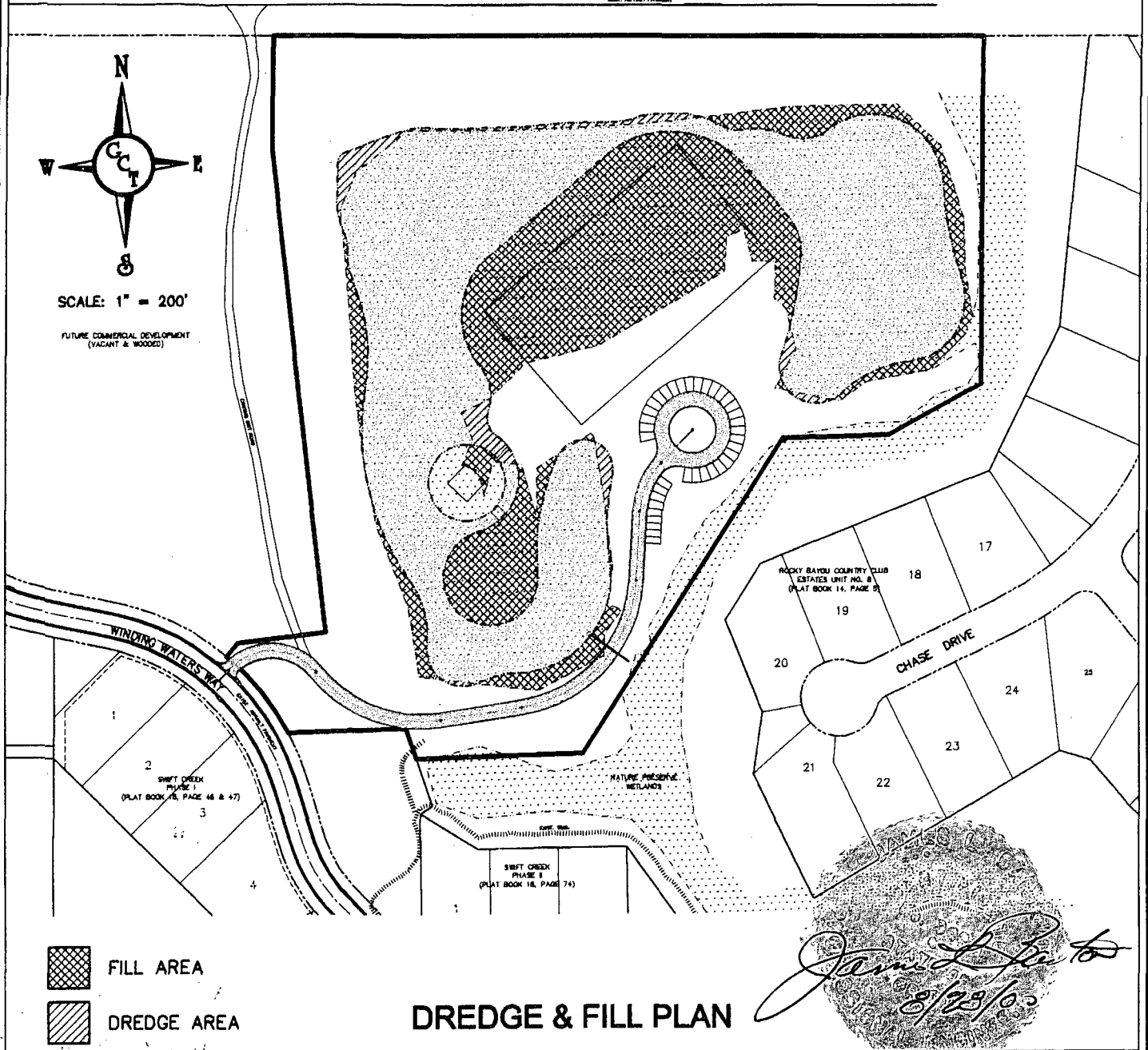



- FILL AREA
- DREDGE AREA

**DREDGE & FILL PLAN**

Applicant: RUCKEL PROPERTIES, INC.  
 County: OKALOOSA  
 Datum: N.G.V.D.  
 Adjacent Property Owner's: SEE SHEET  
 Water Body: STILL BRANCH

Purpose: CONSTRUCTION OF SITE IMPROVEMENTS  
 RELATED TO NEW PARK.  
 Original Work  Maintenance   
 Sheet No. 6 of 14  
 Date: May 9, 2000 Revised: August 7, 2000

### MITIGATION PLANTING LEGEND

KEY	SCIENTIFIC NAME	QUANTITY	SIZE	SPACING
<p style="text-align: center;"><b>33.00-31.50</b></p> 	<i>Sagittaria lancifolia</i>	0.50 AC = 2420	1 qt. / eq.	3' o.c.
<p style="text-align: center;"><b>31.50-30.50</b></p> 	<i>Pontederia cordata</i>	0.44 AC = 2130	1 qt. / eq.	3' o.c.
<p style="text-align: center;"><b>30.50-30.00</b></p> 	<i>Nymphaea odorata</i>	0.21 AC = 370	1 qt. / eq.	5' o.c.

  
*James L. Rector*  
 8/28/00

Applicant: RUCKEL PROPERTIES, INC.  
 County: OKALOOSA  
 Datum: N.G.V.D.  
 Adjacent Property Owner's: SEE SHEET  
 Water Body: STILL BRANCH

Purpose: CONSTRUCTION OF SITE IMPROVEMENTS  
 RELATED TO NEW PARK.  
 Original Work  Maintenance   
 Sheet No. 7 of 14  
 Date: May 9, 2000 Revised: August 7, 2000

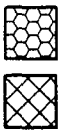
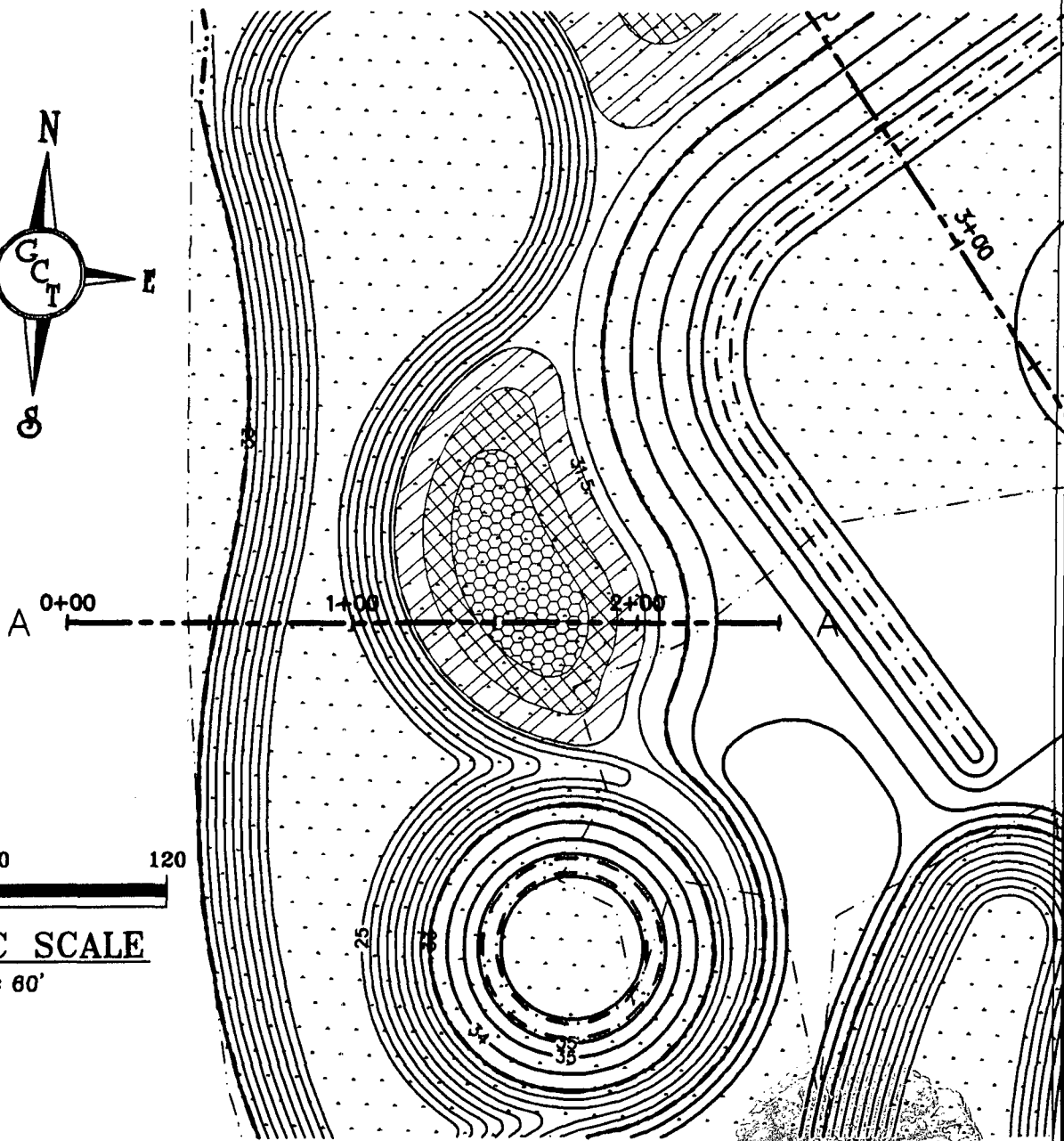
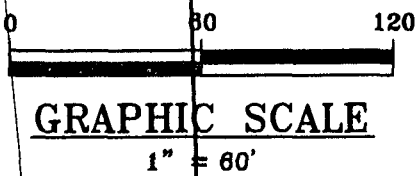
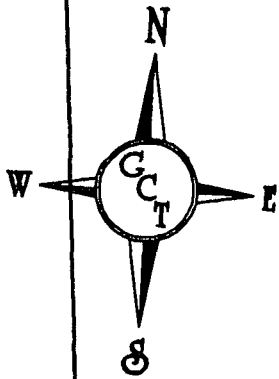

NYMPHEA ODORATA



PONTERDERIA CORDATA



SAGITTARIA LANCIFOLIA

### SECTION A-A PLAN VIEW

*Jan L. B. to*  
8/23/00

Applicant: RUCKEL PROPERTIES, INC.  
County: OKALOOSA  
Datum: N.G.V.D.  
Adjacent Property Owner's: SEE SHEET  
Water Body: STILL BRANCH

Purpose: CONSTRUCTION OF SITE IMPROVEMENTS  
RELATED TO NEW PARK.  
Original Work  Maintenance   
Sheet No. 8 of 14  
Date: May 9, 2000 Revised: August 7, 2000

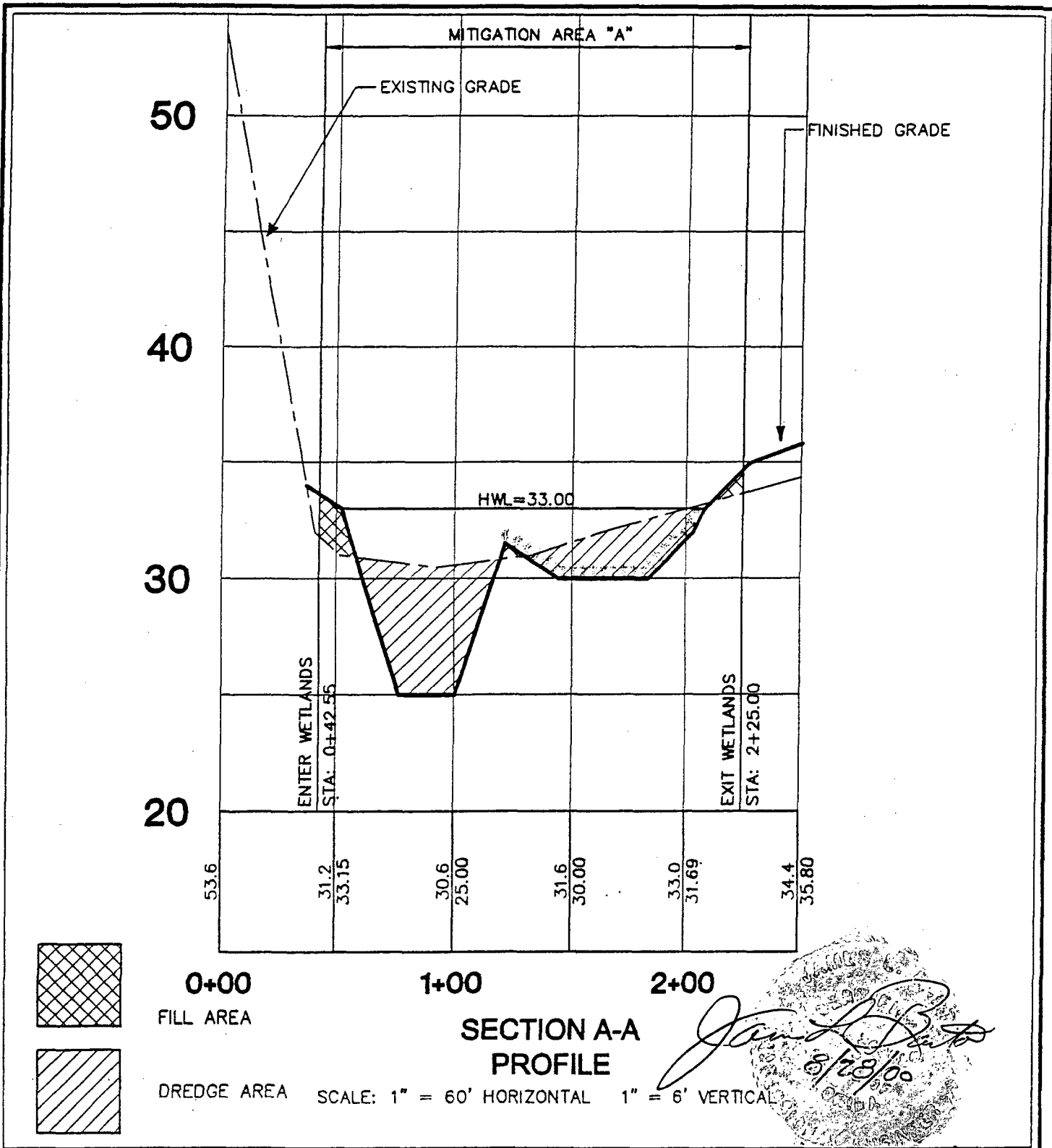

Applicant: RUCKEL PROPERTIES, INC.  
 County: OKALOOSA  
 Datum: N.G.V.D.  
 Adjacent Property Owner's: SEE SHEET  
 Water Body: STILL BRANCH

Purpose: CONSTRUCTION OF SITE IMPROVEMENTS  
 RELATED TO NEW PARK.  
 Original Work  Maintenance   
 Sheet No. 9 of 14  
 Date: May 9, 2000

**GRAPHIC SCALE**

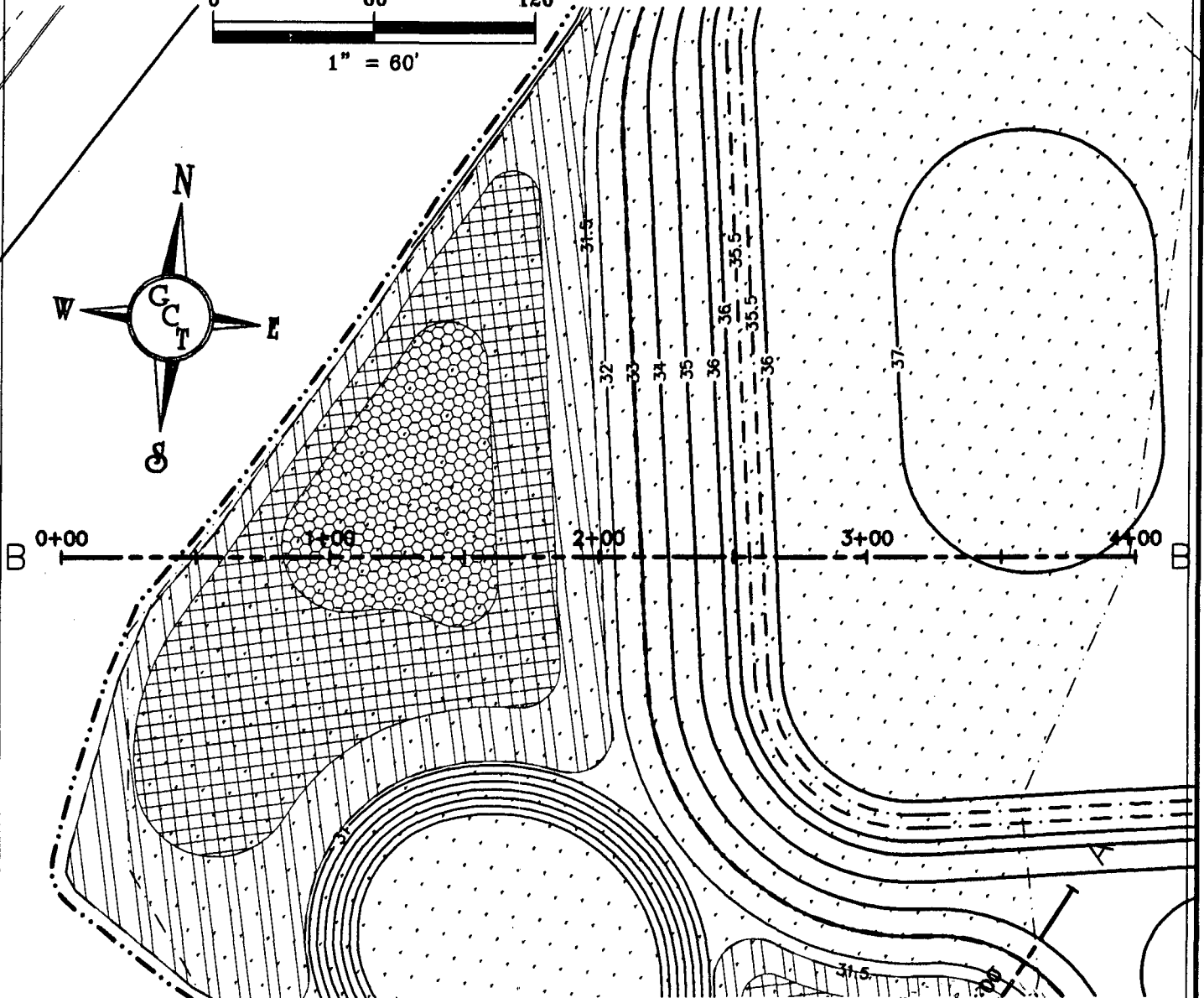
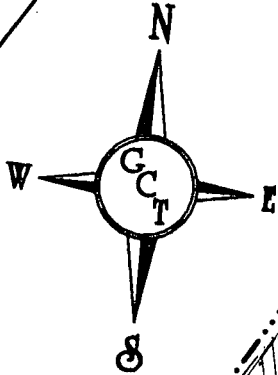
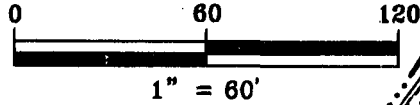

NYMPHEA ODORATA



PONTERDERIA CORDATA



SAGITTARIA LANCIFOLIA

**SECTION B-B  
PLAN VIEW**

JAMES L. BARTON  
REGISTERED PROFESSIONAL ENGINEER  
No. 50393  
STATE OF FLORIDA  
*James L. Barton*  
8/28/00

Applicant: RUCKEL PROPERTIES, INC.  
County: OKALOOSA  
Datum: N.G.V.D.  
Adjacent Property Owner's: SEE SHEET  
Water Body: STILL BRANCH

Purpose: CONSTRUCTION OF SITE IMPROVEMENTS  
RELATED TO NEW PARK.  
Original Work  Maintenance   
Sheet No. 10 of 14  
Date: May 9, 2000 Revised: August 7, 2000





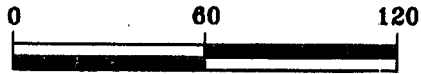

**GRAPHIC SCALE**

1" = 60'

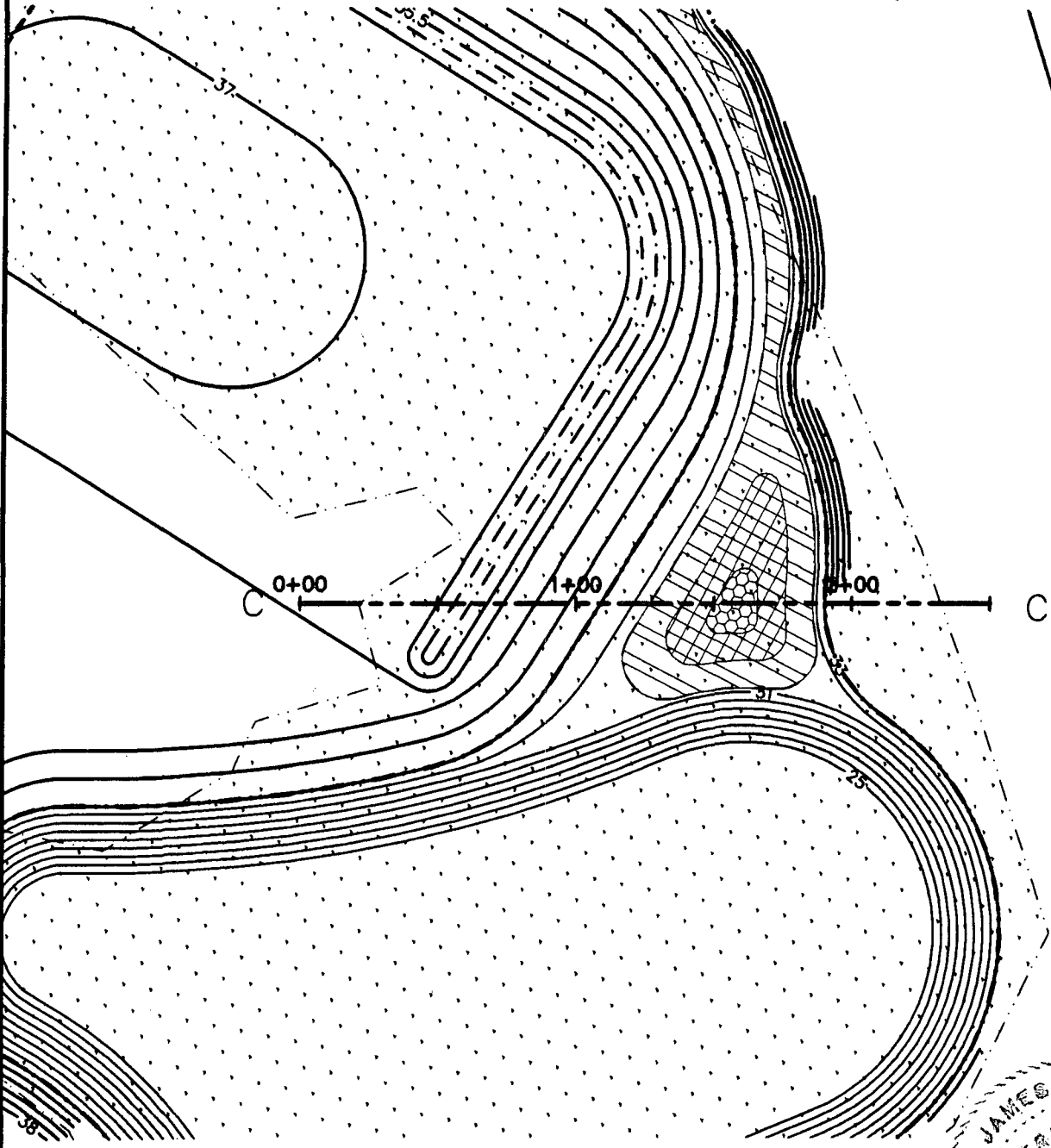
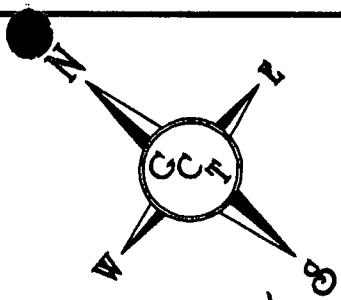

NYPHEA ODORATA



PONTERERIA CORDATA

**SECTION C-C  
PLAN VIEW**



SAGITTARIA LANCIFOLIA

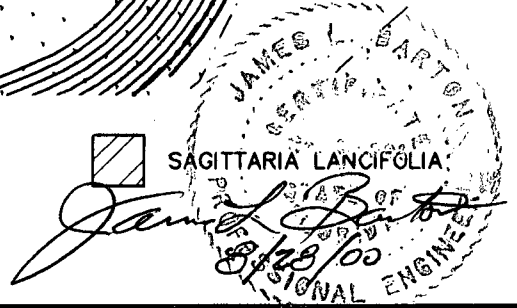

Applicant: RUCKEL PROPERTIES, INC.  
 County: OKALOOSA  
 Datum: N.G.V.D.  
 Adjacent Property Owner's: SEE SHEET  
 Water Body: STILL BRANCH

Purpose: CONSTRUCTION OF SITE IMPROVEMENTS  
 RELATED TO NEW PARK.  
 Original Work  Maintenance   
 Sheet No. 12 of 14  
 Date: May 9, 2000 Revised: August 7, 2000

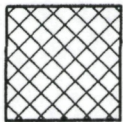
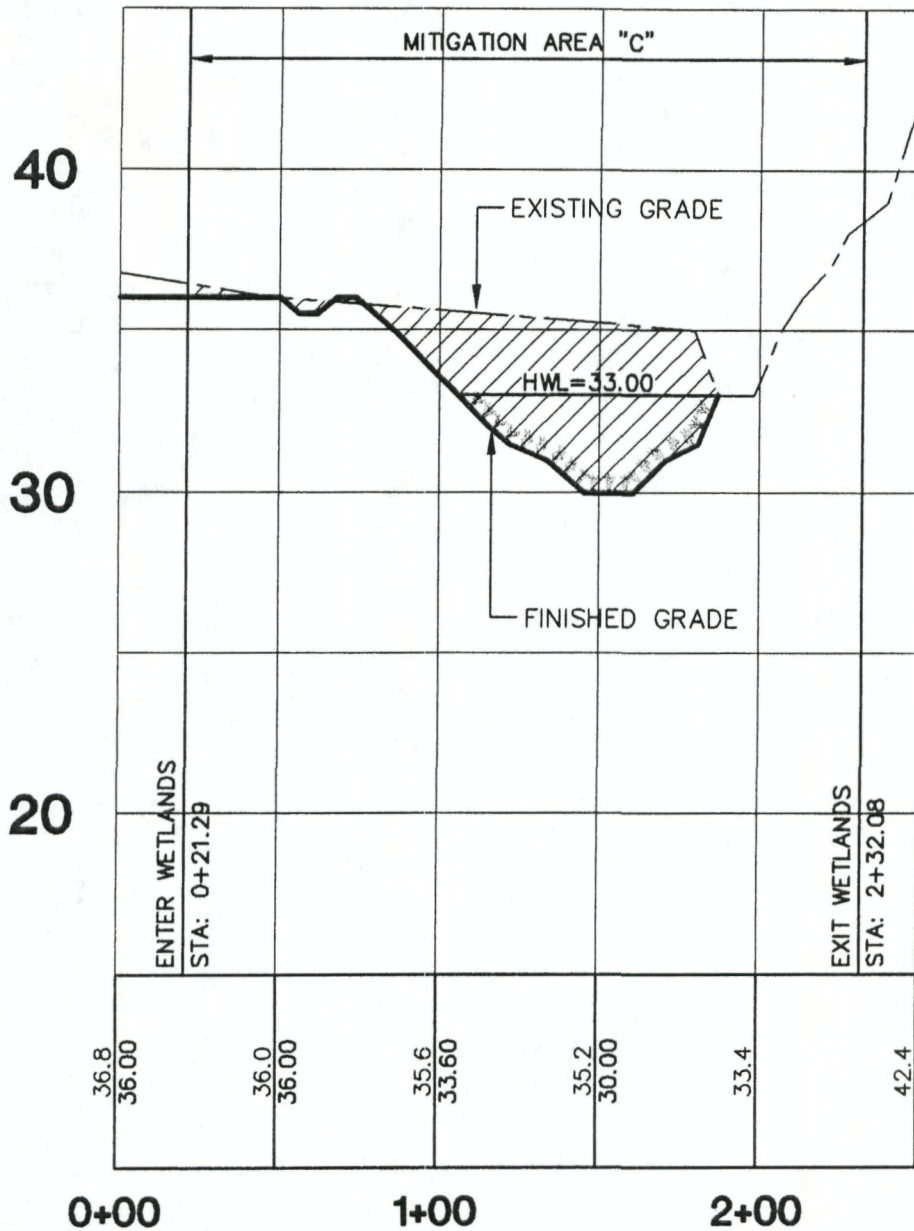

FILL AREA

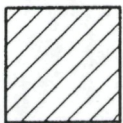

DREDGE AREA

### SECTION C-C PROFILE

SCALE: 1" = 60' HORIZONTAL 1" = 6' VERTICAL

*James L. Barton*  
 JAMES L. BARTON  
 PROFESSIONAL ENGINEER  
 8/28/00

Applicant: RUCKEL PROPERTIES, INC.  
 County: OKALOOSA  
 Datum: N.G.V.D.  
 Adjacent Property Owner's: SEE SHEET  
 Water Body: STILL BRANCH

Purpose: CONSTRUCTION OF SITE IMPROVEMENTS  
 RELATED TO NEW PARK.  
 Original Work  Maintenance   
 Sheet No. 13 of 14  
 Date: May 9, 2000 Revised: August 7, 2000

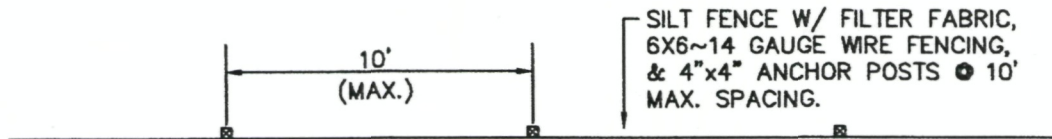

**PLAN**

**CONSTRUCTION NOTE:**

1. INSTALL 4"x4" WOOD POSTS ALONG BARRIER LINE (10' MAX. SPACING, 18" MIN. EMBEDMENT). EXCAVATE 4" WIDE BY 4" DEEP TRENCH ALONG POST LINE, UPSLOPE OF BARRIER. FASTEN WIRE MESH FENCING TO 4"x4" POSTS WITH HEAVY DUTY WIRE STAPLES AT LEAST 1 INCH LONG, TIE WIRES OR HOG RINGS. STAPLE OR WIRE FILTER FABRIC TO UPSLOPE SIDE OF SUPPORT FENCING. EXTEND 8" OF FABRIC AND FENCING INTO TRENCH AND BACKFILL.
2. WHEN EXTRA STRENGTH FABRIC IS USED AND POSTS ARE SPACED 6 FEET INSTEAD OF 10 FEET APART, THE WIRE MESH SUPPORT FENCE MAY BE ELIMINATED. IN SUCH A CASE, THE FILTER FABRIC IS STAPLED OR WIRED DIRECTLY TO THE POSTS.

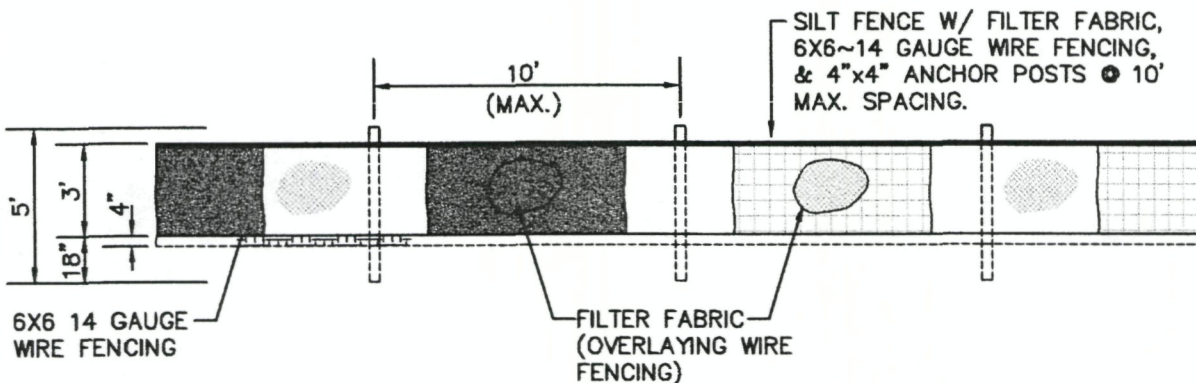

**ELEVATION**

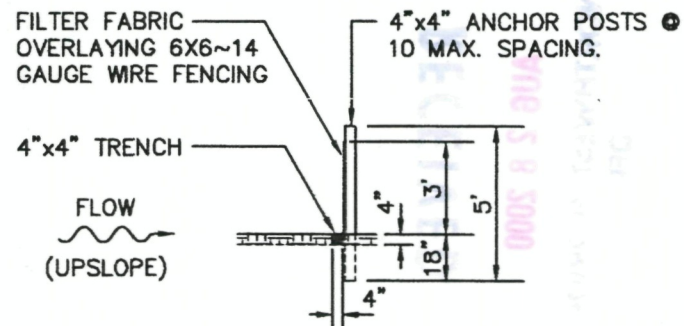

**SECTION**

**EROSION CONTROL DETAIL**

N.T.S.

James L. Barton
   
 8/28/00

Applicant: RUCKEL PROPERTIES, INC.  
 County: OKALOOSA  
 Datum: N.G.V.D.  
 Adjacent Property Owner's: SEE SHEET  
 Water Body: STILL BRANCH

Purpose: CONSTRUCTION OF SITE IMPROVEMENTS  
 RELATED TO NEW PARK.  
 Original Work  Maintenance   
 Sheet No. 14 of 14  
 Date: May 9, 2000 Revised: August 7, 2000



Jeb Bush  
Governor

# Department of Environmental Protection

Northwest District  
160 Governmental Center  
Pensacola, Florida 32501-5794

David B. Struhs  
Secretary

June 20, 2000

Mr. John C. Gustin, III  
121 Hart Street  
Niceville, FL. 32578

File No: 46-0070659-002  
Applicant: Ruckel Properties, Inc.

Dear Mr. Gustin,

This is to acknowledge receipt of your application on May 26, 2000 for a Individual Wetland Resource Permit, pursuant to Part IV, Chapter 373, Florida Statutes, and an authorization to use state-owned submerged lands, pursuant to Chapters 253, Florida Statutes.

In order to review your application, we need the additional information listed below by September 21, 2000. If necessary, you may request an extension up to 90 additional days. If neither the information nor a request for an extension is received by September 21, 2000, your application may be denied without prejudice. If you revise your project after submitting the initial joint application, please contact us as soon as possible.

Sincerely,

Patti Salvaggio  
Submerged Lands & Environmental  
Resources Program

Applicant: Ruckel Properties, Inc.  
Application No.: 46-0070659-002

1. Please provide an 8 1/2 x 11 plan view that shows the location of the three cross sections.  
[ ]
2. On the cross sections, indicate the ordinary high water line. [ ]
3. On the plan view indicate the DEP wetland jurisdictional line. [ ]
4. Please clarify if the proposed littoral shelves are proposed as off-setting mitigation for the impacts. [ ]
5. Please provide a stormwater plan or indicate if you intend to apply for this separately.  
[ ]
6. What are the small squares around the cul de sac as indicated on the plan view?  
[ ]
7. What is the structure located in the circular area on the south west side of the project? Has that been included in the estimate of impacts? [ ]
8. Describe the purpose of the playing field, how it will be surfaced and how the slopes will be stabilized? [ ]
9. It appears that you are proposing to dredge the lakes to -5 feet. Please indicate the method for dredging and the location and manner of disposal of the dredge material. Provide a spoil disposal detail, including discharge details, locations, retention plans, volumes, and data used to size the disposal cell(s). [ ]
10. You indicate that the ground water shall be piped to an existing retention pond. Records appear to indicate that the retention pond was part of the stormwater plan for Swift Creek Phase I and therefore, groundwater may not be pumped into this pond. Please address this issue including the volume of ground water that is involved. **Note: you may need a consumptive use permit from the Northwest Florida Water Management District.**  
[ ]
11. If demucking is proposed, provide the estimated cubic yardage and location of the storage or disposal site of the muck, and whether or not the muck will be used as slope dressing.  
[ ]
12. Provide fully dimensioned or scaled cross sectional views of typical roadway sections and work proposed at culvert locations. One or two typical sections may be sufficient where roadway sections remain relatively consistent. Where topographic, roadway, or other features change additional cross sectional views will be required to adequately reflect changes in existing and proposed conditions. [ ]

13. Provide in detail the methods and equipment which are proposed to be employed in accomplishing the proposed project. If known, indicate the timing and staging of the project. Include all anticipated methods and materials which will be employed to stabilize slopes and protect adjacent waters from erosion of sediments and other harmful materials from the work site. [       ]

14. If dewatering will be required, provide complete details of temporary dikes, discharge locations, time periods, and methods for preventing turbid discharges. [       ]

Patti

46-0070659-002 JF



DEPARTMENT OF THE ARMY  
JACKSONVILLE DISTRICT CORPS OF ENGINEERS  
PANAMA CITY REGULATORY OFFICE  
475 HARRISON AVENUE, SUITE 202  
PANAMA CITY, FLORIDA 32401-2731

REPLY TO  
ATTENTION OF

Regulatory Division  
North Permits Branch  
Panama City Regulatory Office  
200002593(IP-DH)

June 29, 2000

RECEIVED

JUN 30 2000

NORTHWEST FLORIDA  
DEP

Mr. John C. Gustin III  
Gustin, Cothorn & Tucker, Inc.  
121 Hart Street  
Niceville, Florida 32578

Dear Mr. Gustin:

Reference is made to the Department of the Army permit application you submitted on behalf of Ruckel Properties, Inc. for the placement of fill into and excavation of waters of the United States, associated with Still Branch in Section 4, Township 01 South, Range 22 West, Okaloosa County, Florida. The application has been assigned number 200002593(IP-DH). Please refer to this number in future correspondence.

The application and drawings are not sufficient for us to fully evaluate your application. Please provide the following information:

a. On the plan view drawing show and label the jurisdiction line delineating waters of the United States, including wetlands, under the regulatory jurisdiction of the U.S. Army Corps of Engineers (Corps). The jurisdiction delineation must be in compliance with Corps regulations and the *Corps of Engineers Wetlands Delineation Manual* (1987). All drawings and calculations of impacts must show and be calculated in reference to impacts in Corps' regulated waters, including wetlands. Please assure that we are provided a full set of drawings that are clear and legible. The drawings we received from the FDEP are of poor quality.

b. What is the purpose of the project? What is the need for the project? Identify the various components of the proposed project on the plan view drawings.

c. Provide a self-adhesive mailing label for each of the adjacent property owners.

Please be advised that Still Branch has been found to harbor the Federally endangered species, Okaloosa Darter (*Etheostoma okaloosae*). You may wish to contact Ms. Lorna Patrick of the Panama City Office of the U.S. Fish and Wildlife Service at (850)769-0552, ext. 229, to discuss the Service's concerns regarding your proposed project in reference to this species.

As the application is considered incomplete, no action will be taken on it until the above requested information and drawings have been received. We request you provide this information within 45 days. If no response is received, we will assume you have no further interest in obtaining a Department of the Army permit and the application will be considered withdrawn. Such action will constitute final action by the Department of the Army.

You are cautioned that work performed below the mean high waterline or ordinary high waterline in waters of the United States, or the discharge of dredged or fill material into adjacent wetlands, without a Department of the Army permit could subject you to enforcement action. Receipt of a permit from the Florida Department of Environmental Protection does not relieve you of the requirement to obtain a Department of the Army permit for your proposal.

If you have any questions regarding the application, please contact the undersigned at the letterhead address or by telephone at (850) 763-0717 ext. 25.

Sincerely,

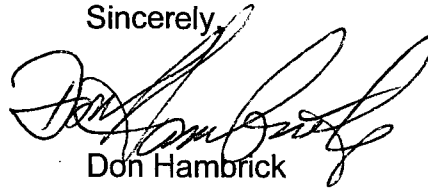
A handwritten signature in black ink, appearing to read "Don Hambrick", written over the word "Sincerely,".

Don Hambrick  
Team Leader

Copy Furnished:

USFWS, Panama City (Patrick)

~~DEP, SLERP, Pensacola~~



Patti

DEPARTMENT OF COMMUNITY AFFAIRS  
Wendy Wood, Florida State Clearinghouse  
Intergovernmental Coordination and Review  
2555 Shumard Oak Blvd ... Tallahassee, FL 32399-2100  
(850)414-6576 ... (SC) 994-6576

MEMORANDUM

TO: Patti Salvaggio  
Department of Environmental Protection  
Northwest District

FROM: Wendy Wood, Florida State Clearinghouse

SUBJECT: File Number: 0070659002

Applicant Name: Ruckel Properties, Inc.

County: Okaloosa

DATE: 06/22/2000

---

---

We have reviewed the application, per your request, and have no objections to the proposed project.

Thank you for the opportunity to provide agency comments. If you have any questions or concerns regarding this matter, you may contact Cherie Trainor at (850) 414-5495.



6-15-00  
Looking to  
A  
from C



6-15-00  
Looking to  
B from A

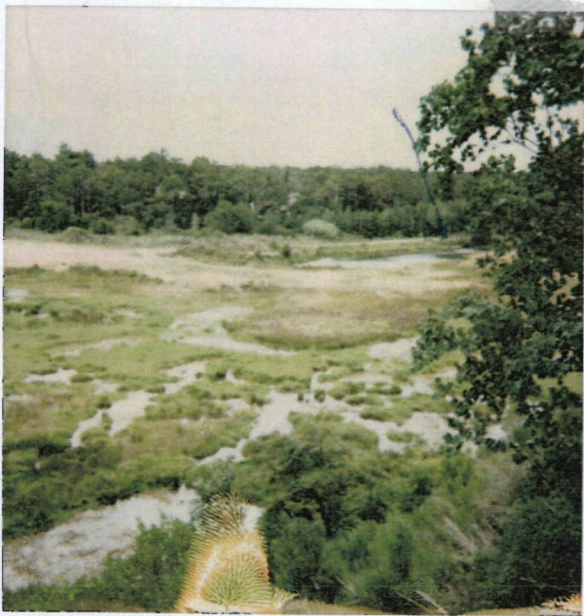

6-15-00  
Looking to  
C-B



Looking to B  
from C  
6-15-00



6-15-00  
Looking to D



# Department of Environmental Protection

Lawton Chiles  
Governor

Northwest District  
160 Governmental Center  
Pensacola, Florida 32501-5794

Virginia B. Wetherell  
Secretary

William A. Harrison, Chairman  
Okaloosa County Commission  
101 James Lee Boulevard  
Crestview, Florida 32536

MAY 31 2000

Dear Mr. Harrison:

Enclosed is a short form application (File No. 46-0070659-002-9F) (Name: Luciel Properties) which involves dredge and fill jurisdiction. Section 403.916, Florida Statutes, as amended by the 1984 session of the Florida Legislature, requires the Department to notify the local government within ten (10) days of receipt of an application for a dredge and fill permit. The local government has twenty-one (21) days from the time it received the notification for a short-form application and sixty (60) days from the time it receives the notification for a standard form application to file objections to the application.

Furthermore, the local government may participate as a party to the procedure and may request a hearing pursuant to Section 120.57, Florida Statutes, within twenty-one (21) days after receiving notice of the Department's intent. If the local government does not file objections within the designated time period or request an intent letter, the Department will assume that the local government does not wish to receive a notice of intent.

Objections should be mailed to me at the Department of Environmental Protection, Northwest District, 160 Governmental Center, Suite 308, Pensacola, Florida 32501-5794, and should reference the file number.

If you have any questions, please contact the Department.

Sincerely,

Connie A. Krystof  
Program Administrator  
Submerged Lands & Environmental  
Resources Program

CAK:wb  
Enclosures

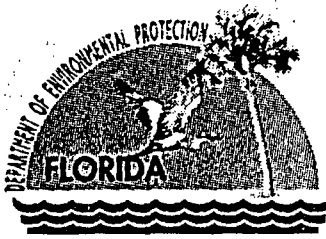

# Department of Environmental Protection

Jeb Bush  
Governor

Northwest District  
160 Governmental Center  
Pensacola, Florida 32501-5794

David B. Struhs  
Secretary

TO: Department of Community Affairs  
Office of Intergovernmental Affairs  
Attn: John Barker

FROM: Patti Salvaggio

DATE: MAY 31 2000

SUBJ: File No. 46-0070659-002-DF  
Applicant: Ruchel Properties, Inc.

The Department is currently processing the attached application. If you have any comments on or objections to this project, please submit them in writing to this office on or before June 31, 2000.

Please refer to the applicant's name and file number in any correspondence to help facilitate processing. Questions concerning this project should be addressed to Patti Salvaggio at (850) 595-8300, Ext. 1127.

/wb

Attachment



# GUSTIN, COTHERN, & TUCKER, INC.

LAND SURVEYORS/ENGINEERS

121 Hart Street

Niceville, Florida 32578

☎ Phone (850) 678-5141

☎ Fax (850) 729-2460

May 24, 2000

Ms. Patti Salvaggio  
Florida Department of Environmental Protection  
160 Governmental Street  
Pensacola, Florida 32501

RE: **Swift Creek Park**

Dear Ms. Salvaggio:

Please find enclosed the proposed dredge & fill for the old Ruckel Sand pit property. The project consists of reshaping the lakes and creating a playfield for residents in the Swift Creek subdivision.

Construction plans will be submitted to stormwater department for approval.

If you have any questions, please call at (850) 678-5141.

Sincerely,

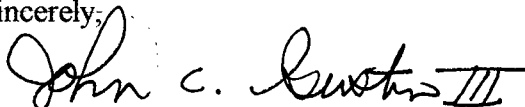
  
John C. Gustin, III

RECEIVED  
MAY 26 2000  
NORTHWEST FLORIDA  
DEP



Florida Department of Environmental Regulation

Twin Towers Office Bldg. • 2600 Blair Stone Road • Tallahassee, Florida 32399-2400

DER Form # 17-312(8001)
Form Title: Joint Ap. for Works in the Waters of Florida
Effective Date: October 30, 1991
DER Application No. (Filed in by DER)

Joint Application for Works in the Waters of Florida

Department of the Army (Corps)/Florida Department of Environmental Regulation (DER)/
Department of Natural Resources (DNR)/Delegated Water Management District (Delegated WMD)

Type or Print Legibly

Corps Application Number (official use only) DER Application Number (official use only)

1. Applicant's Name and Address
Name: Ruckel Properties, Inc.
Street: 17 John Sims Parkway
City: Niceville State: Florida Zip: 32580
Telephone: (850) 678-2224

2. Name, Address, Zip Code, Telephone Number and Title of Applicant's Authorized Agent
Name: John C. Gustin, III - Project Manager
Corporate Name: Gustin, Cothorn, & Tucker, Inc.
Street: 121 Hart Street
City: Niceville State: Florida Zip: 32578
Telephone: (850) 678-5141

3. Name of Waterway at Work Site: Still Branch

4. Street, Road or Other Location of Work: Southeast corner of College Boulevard & existing dirt road
Incorporated City or Town:
Section 4 Township 1 South Range 22 West
County(ies): Okaloosa
Coordinates in Center of Project: Latitude 30 32 9 Longitude 86 27
Directions to Locate Site: Take S.R. 285 from I-10 to College Boulevard. The project is located on the southeast corner of College Boulevard and existing dirt road approximately about 1/3 of a mile from the intersection of S.R. 285 and College Boulevard

5. Names, Addresses, and Zip Codes of Adjacent Property Owners Whose Property Also Adjoins the Water (Excluding Applicant).
1. Ruckel Properties, iInc. P.O. Box 187 Valparaiso, Fl 32580
2. Andrew & Elizabeth Beno 1023 Christy Drive Niceville, Fl. 32578
3. Lawrence Earl Campbell, Jr. 805 Sparkleberry Cv Niceville, Fl 32578
4. Jefferson & Gaylin Severs 1096 Forest Lake Tr Niceville, Fl 32576
5. John H. Kirnin 6112 Lapreniere Street St Metairie, La 70003
6. Danny & Amy Jones 4406 South Minster Circle Niceville, Fl 32578

6. Proposed Use (Check one or more as applicable) Private Single Family  Multi Family   
 Public  Commercial  New Work  Alteration of Existing Works  Maintenance  Other (Explain) Park

7. Desired Permit Duration (see Fee Schedule)  
 5 Yr  10 Yr  Other (Specify) \_\_\_\_\_

8. General Permit or Exemption Requested  
 DER General Permit FAC Rule 17-312. X DER Exemption FAC Rule 17-312. \_\_\_\_\_ Section 403 \_\_\_\_\_ F.S.

9. Total Extent of Work in Jurisdictional Open Waters or Wetlands: (Use additional sheets and provide complete breakdown of each category if more space is needed.)

a. Within Corps Jurisdiction:  
 Fill: 60,224 Sq. Ft. 1.38 Acres 10,980 Cu. Yds.  
 Excavation: 42,794 Sq. Ft. 0.98 Acres 18,826 Cu. Yds.

b. Within DER Jurisdiction:  
 Fill: 60,224 Sq. Ft. 1.38 Acres 10,980 Cu. Yds.  
 Excavation: 42,794 Sq. Ft. 0.98 Acres 18,826 Cu. Yds.  
 Excavation Waterward of MHW \_\_\_\_\_ cu. yds. (Information needed for DNR)

**RECEIVED**  
**MAY 26 2000**  
 NORTHWEST FLORIDA  
 DEP

c. DER Jurisdictional Area Severed (Area Landward of Fill Structures which will be Severed):  
 \_\_\_\_\_ Sq. Ft. \_\_\_\_\_ Acres

d. DER Jurisdictional Area Created (New Excavation from Uplands, Exclusive of Mitigation):  
 \_\_\_\_\_ Sq. Ft. \_\_\_\_\_ Acres

e. Docks, Piers, and Over Water Structures:  
 Total Number of Slips \_\_\_\_\_ Total Number of Mooring Pilings \_\_\_\_\_  
 Length \_\_\_\_\_ Width \_\_\_\_\_ Height above MHW \_\_\_\_\_  
 Length \_\_\_\_\_ Width \_\_\_\_\_ Height above MHW \_\_\_\_\_  
 Number of Finger Piers \_\_\_\_\_ Length \_\_\_\_\_ Width \_\_\_\_\_ Height \_\_\_\_\_  
 Number of Finger Piers \_\_\_\_\_ Length \_\_\_\_\_ Width \_\_\_\_\_ Height \_\_\_\_\_  
 Total area of structure over waters & wetlands \_\_\_\_\_ sq. ft.  
 Use of structure \_\_\_\_\_

Will the docking facility provide:	No	Yes	Number
Liveaboard Slips	<input type="checkbox"/>	<input type="checkbox"/>	_____
Fueling Facilities	<input type="checkbox"/>	<input type="checkbox"/>	_____
Sewage Pump-out Facilities	<input type="checkbox"/>	<input type="checkbox"/>	_____
Other Supplies or Services Required for Boating (Excluding refreshments, bait and tackle)	<input type="checkbox"/>	<input type="checkbox"/>	_____

f. Seawall length \_\_\_\_\_ ft. Seawall material \_\_\_\_\_  
 Riprap revetment length \_\_\_\_\_ ft. Slope \_\_\_\_\_ H: \_\_\_\_\_ V Toe width \_\_\_\_\_ ft.  
 Riprap at toe of seawall length \_\_\_\_\_ ft. Slope \_\_\_\_\_ H: \_\_\_\_\_ V Toe width \_\_\_\_\_ ft.  
 Size of riprap \_\_\_\_\_  
 Type of riprap or seawall material \_\_\_\_\_

g. Other (See Item 10).



10. Description of Work (be specific; use additional sheets as necessary).

Consists of dredging and filling 2.36 acres. To reshape lakes. 1.15 acres of littoral shelves will be created with wetland plantings in these areas.

11. Turbidity, Erosion, and Sedimentation Controls Proposed:

During construction, the outfall structure will be closed and the groundwater will be pumped to the existing retention area just south of the project. This water will be allowed to percolate into retention basin. Silt fences will be installed along any areas of disturbance which could lead to soil being deposited into wetlands. Any areas of disturbance will be solid sodded immediately after construction

12. Date Activity is Proposed to Commence Upon approval ; to be Completed \_\_\_\_\_  
 Total Time Required to Construct \_\_\_\_\_

13. Previous Applications for this Project have been: N/A DER No. \_\_\_\_\_ Corps No. \_\_\_\_\_  
 A. Denied (date) \_\_\_\_\_  
 B. Issued (date) \_\_\_\_\_  
 C. Other (please explain) \_\_\_\_\_  
 Differentiate between existing work and proposed work on the drawings.

**RECEIVED**  
**MAY 26 2000**  
**NORTHWEST FLORIDA**  
**DER**

14. Certification. Application is hereby made for a permit or permits to authorize the activities described herein.

A. I Certify That: (Please check appropriate space)

- 1. I am the record owner  ; lessee  , or the record easement holder  of the property on which the proposed project is to be undertaken, as described in the attached legal document.
- 2. I am not  the record owner, lessee, or record easement holder of the property on which the proposed project is to be undertaken, as described in the attached legal document, but I will have, before undertaking the proposed work, the requisite property interest. (Please explain what the interest will be and how it will be acquired.)

Attach legal description of property or copy of deed to the property on which project is to occur (must be provided)

B. I understand I may have to provide any additional information/data that may be necessary to provide reasonable assurance or evidence that the proposed project will comply with the applicable State Water Quality Standards or other environmental standards both before construction and after the project is completed.

C. In addition, I agree to provide entry to the project site for inspectors with proper identification or documents as required by law from the environmental agencies for the purpose of inspecting the site. Further, I agree to provide entry to the project site for such inspectors to monitor permitted work, if a permit is granted.

D. This is a Joint Application and is not a Joint Permit. I hereby acknowledge the obligation and responsibility for obtaining all of the required state, federal or local permits before commencement of construction. I also understand that before commencement of this proposed project, I must be granted separate permits or authorizations from the U.S. Corps of Engineers, the U.S. Coast Guard, the Department of Environmental Regulation, the Delegated Water Management District (where applicable), and the Department of Natural Resources, as necessary.

DER Form #	17-312.900(1)
Form Title	Joint Ap. for Work in the Waters of Florid
Effective Date	October 30, 1991
DER Application No.	(Filed in by DER)

E. I am familiar with the information contained in this application, and that to the best of my knowledge and belief, such information is true, complete and accurate. I further certify that I possess the authority to undertake the proposed activities or am acting as the duly authorized agent of the applicant. I understand that knowingly making any false statement or representation in this application is a violation of Section 403.161, F.S. and Chapter 837, F.S.

John C. Gustin, III

Typed/Printed Name of Applicant or Agent

*John C. Gustin III*  
Signature of Applicant or Agent

5/24/00  
Date

Project Manager

(Corporate Title if applicable)

AN AGENT MAY SIGN ABOVE IF APPLICANT COMPLETES THE FOLLOWING:

I hereby designate and authorize the agent listed above to act on my behalf as my agent in the processing of this permit application and to furnish on request, supplemental information in support of the application.

James R. Ruckel

Typed/Printed Name of Applicant

*James R. Ruckel*  
Signature of Applicant

5/24/00  
Date

Development Manager

(Corporate Title if applicable)

15. **For your information:** Section 370.034, Florida Statutes, requires that all dredge and fill equipment owned, used, leased, rented or operated in the state shall be registered with the Department of Natural Resources. Before selecting your contractor or equipment you may wish to determine if this requirement has been met. For further information, contact the Chief of the Bureau of Saltwater Licenses and Permits, Department of Natural Resources, 3900 Commonwealth Boulevard, Tallahassee, Florida 32399. Telephone No. (904) 487-3122. **This is not a requirement for a permit from the Department of Environmental Regulation.**

18 U.S.C. Section 1001 provides that, Whoever, in any manner within the jurisdiction of any department or agency of The United States knowingly and willfully falsifies, conceals, or covers up by any trick, scheme, or device a material fact or makes any false, fictitious or fraudulent statements or representations or makes or uses any false writing or document knowing same to contain any false, fictitious or fraudulent statement or entry, shall be fined not more than \$10,000 or imprisoned not more than five years, or both.

16. Please submit this completed form, with attached drawings and the complete DER processing fee (see Fee Schedule in Rule 17-4050, F.A.C., copy attached) to the appropriate DER or Delegated WMD office with jurisdiction over the project site.

RECEIVED

MAY 26 2000

NORTHWEST FLORIDA  
DEP

## ADJACENT PROPERTY OWNERS

- 1) Mark A. & Jeanne M. Mello  
527 Matthew Street  
Niceville, Florida 32578
- 2) John T. & Shelby B. Dubose  
2398 Chase Drive  
Niceville, Florida 32578
- 3) William & Terri Markowski  
2196 Chase Drive  
Niceville, Florida 32578
- 4) John S. & Nita Jordan, III  
2194 Chase Drive  
Niceville, Florida 32578
- 5) Earl S. & Gail S. Paris  
2192 Chase Drive  
Niceville, Florida 32578
- 6) Lucille E. Schaefer  
c/o Trust Company of Oklahoma  
P.O. Box 3627  
Tulsa, OK 74101
- 7) Bruce C. & Susan J. Shepard  
2184 Chase Drive  
Niceville, Florida 32578
- 8) Henry & Carol Zmuda  
2182 Chase Drive  
Niceville, Florida 32578
- 9) Timothy & Cristy Perry  
2180 Chase Drive  
Niceville, Florida 32578
- 10) William T. Gaskell, Jr.  
2178 Chase Drive  
Niceville, Florida 32578

RECEIVED

MAY 26 2000

NORTHWEST FLORIDA  
DEP

**SHEET NO.**

**DESCRIPTION**

1	VICINITY MAP
2	LEGAL DESCRIPTION
3	SITE PLAN
4	GRADING PLAN
5	DREDGE & FILL PLAN
6	PLANTING SCHEDULE
7	SECTION A-A PLAN VIEW
8	SECTION A-A PROFILE
9	SECTION B-B PLAN VIEW
10	SECTION B-B PROFILE
11	SECTION C-C PLAN VIEW
12	SECTION C-C PROFILE
13	EROSION CONTROL DETAIL

RECEIVED

MAY 26 2000  
NORTHWEST FLORIDA  
DIP

*John L. Berto*  
5/24/00

**PROJECT LOCATION**

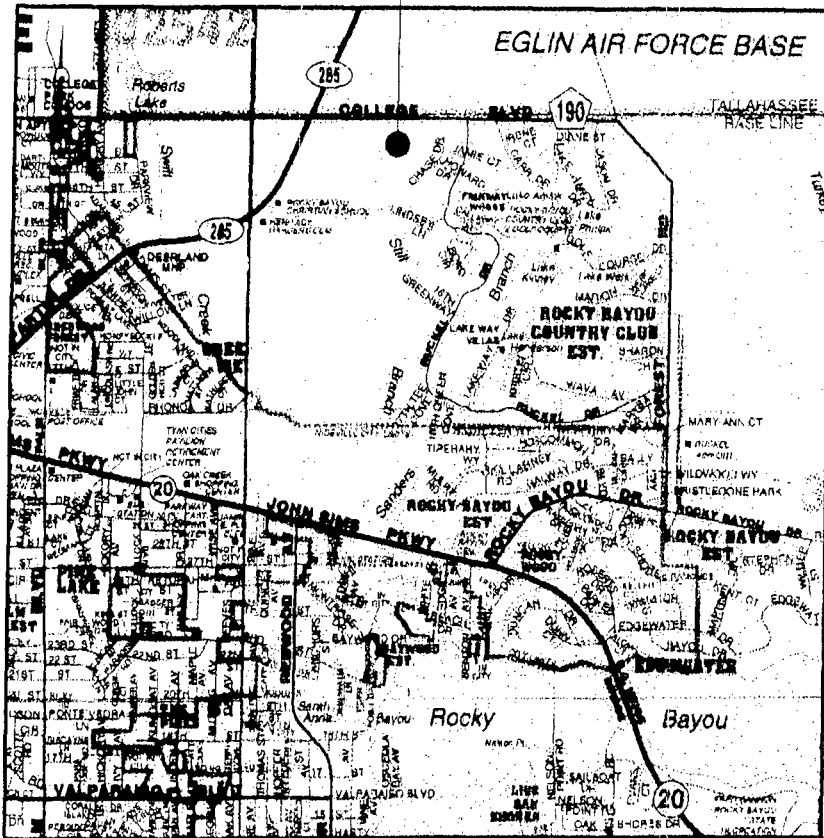

VICINITY MAP

*James L. Bates*  
5/24/00

Applicant: RUCKEL PROPERTIES, INC.  
 County: OKALOOSA  
 Datum: N.G.V.D.  
 Adjacent Property Owner's: SEE SHEET  
 Water Body: STILL BRANCH

Purpose: CONSTRUCTION OF SITE IMPROVEMENTS  
 RELATED TO NEW PARK.  
 Original Work  Maintenance   
 Sheet No. 1 of 13  
 Date: May 9, 2000

## LEGAL DESCRIPTION:

A PARCEL OF LAND LYING IN SECTION 4, TOWNSHIP 1 SOUTH, RANGE 22 WEST, OKALOOSA COUNTY, FLORIDA, AND BEING MORE PARTICULARLY DESCRIBED AS FOLLOWS:

COMMENCE AT THE NORTHERNMOST CORNER OF LOT 1, SWFT CREEK PHASE II, A RESIDENTIAL SUBDIVISION RECORDED IN PLAT BOOK 18, PAGE 74 OF THE PUBLIC RECORDS OF OKALOOSA COUNTY, FLORIDA; SAID POINT ALSO BEING ON THE EASTERLY BOUNDARY LINE OF RETENTION AREA NO. 1 OF SWFT CREEK PHASE I, A RESIDENTIAL SUBDIVISION RECORDED IN PLAT BOOK 18, PAGE 47 OF THE PUBLIC RECORDS OF SAID COUNTY; THENCE ALONG THE EASTERLY BOUNDARY LINE OF SAID RETENTION AREA N59°11'32"E 18.20 FEET; THENCE N16°49'55"W 64.32 FEET TO THE POINT OF BEGINNING; THENCE CONTINUE ALONG SAID RETENTION AREA BOUNDARY LINE N16°49'55"W 41.79 FEET; THENCE S90°00'00"W 153.44 FEET TO A POINT ON THE CURVED NORTHEASTERLY RIGHT-OF-WAY OF WINDING WATERS WAY (60' R/W) AS SHOWN ON THE AFOREMENTIONED PLAT OF SWFT CREEK PHASE I; THENCE NORTHWESTERLY ALONG SAID CURVE BEING CONCAVE TO THE SOUTHWEST AND HAVING A RADIUS OF 330.00 FEET, THROUGH A CENTRAL ANGLE OF 22°20'03" AN ARC DISTANCE OF 128.64 FEET (CHORD = 127.82 FEET; CHORD BEARING = N37°09'27"W) TO A POINT; THENCE, DEPARTING SAID RIGHT-OF-WAY LINE, RUN N41°40'32"E 22.35 FEET; THENCE N85°12'30"E 115.09 FEET; THENCE N04°47'30"W 629.13 FEET; THENCE N01°43'55"E 147.34 FEET TO A POINT ON THE SOUTHERLY RIGHT-OF-WAY LINE OF COLLEGE BOULEVARD (100' R/W); THENCE ALONG SAID RIGHT-OF-WAY LINE S88°16'05"E 924.13 FEET; THENCE, DEPARTING COLLEGE BOULEVARD RUN S01°43'55"W 452.16 FEET; THENCE S62°48'34"W 136.80 FEET; THENCE S90°00'00"W 138.36 FEET; THENCE S34°13'53"W 483.81 FEET; THENCE S90°00'00"W 216.54 FEET TO THE POINT OF BEGINNING.

PARCEL CONTAINS 15.42 ACRES, MORE OR LESS.

*James L. Burt*  
5/24/00

Applicant: RUCKEL PROPERTIES, INC.  
County: OKALOOSA  
Datum: N.G.V.D.  
Adjacent Property Owner's: SEE SHEET  
Water Body: STILL BRANCH

Purpose: CONSTRUCTION OF SITE IMPROVEMENTS  
RELATED TO NEW PARK.

Original Work  Maintenance   
Sheet No. 2 of 13  
Date: May 9, 2000

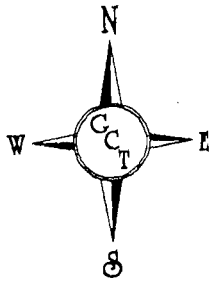

SCALE: 1" = 200'

### LITTORAL SHELF

AREA (S.F.)	ACREAGE
50,088	1.150

COLLEGE BLVD.

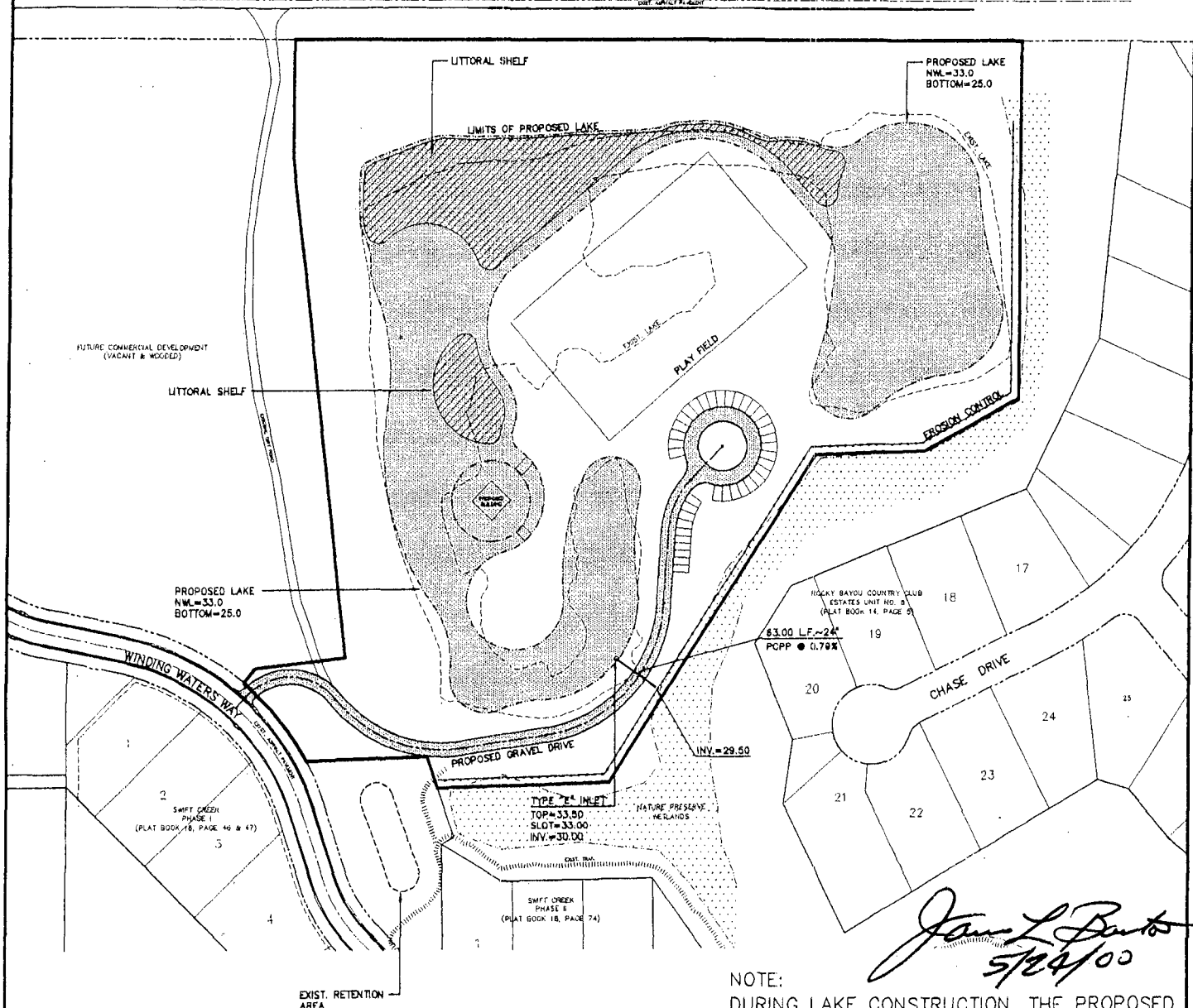

 LITTORAL SHELF

### SITE PLAN

NOTE:

DURING LAKE CONSTRUCTION, THE PROPOSED TYPE "E" INLET (OUTFALL STRUCTURE) WILL BE PLUGGED AND WATER WILL BE PUMPED TO EXISTING RETENTION AREA.

*Jan L. Davis*  
5/24/00

Applicant: RUCKEL PROPERTIES, INC.  
 County: OKALOOSA  
 Datum: N.G.V.D.  
 Adjacent Property Owner's: SEE SHEET  
 Water Body: STILL BRANCH

Purpose: CONSTRUCTION OF SITE IMPROVEMENTS  
 RELATED TO NEW PARK.  
 Original Work  Maintenance   
 Sheet No. 3 of 13  
 Date: May 9, 2000

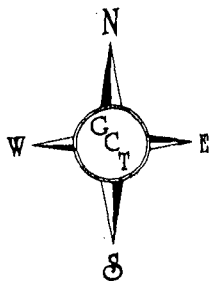

SCALE: 1" = 200'

COLLEGE BLVD.

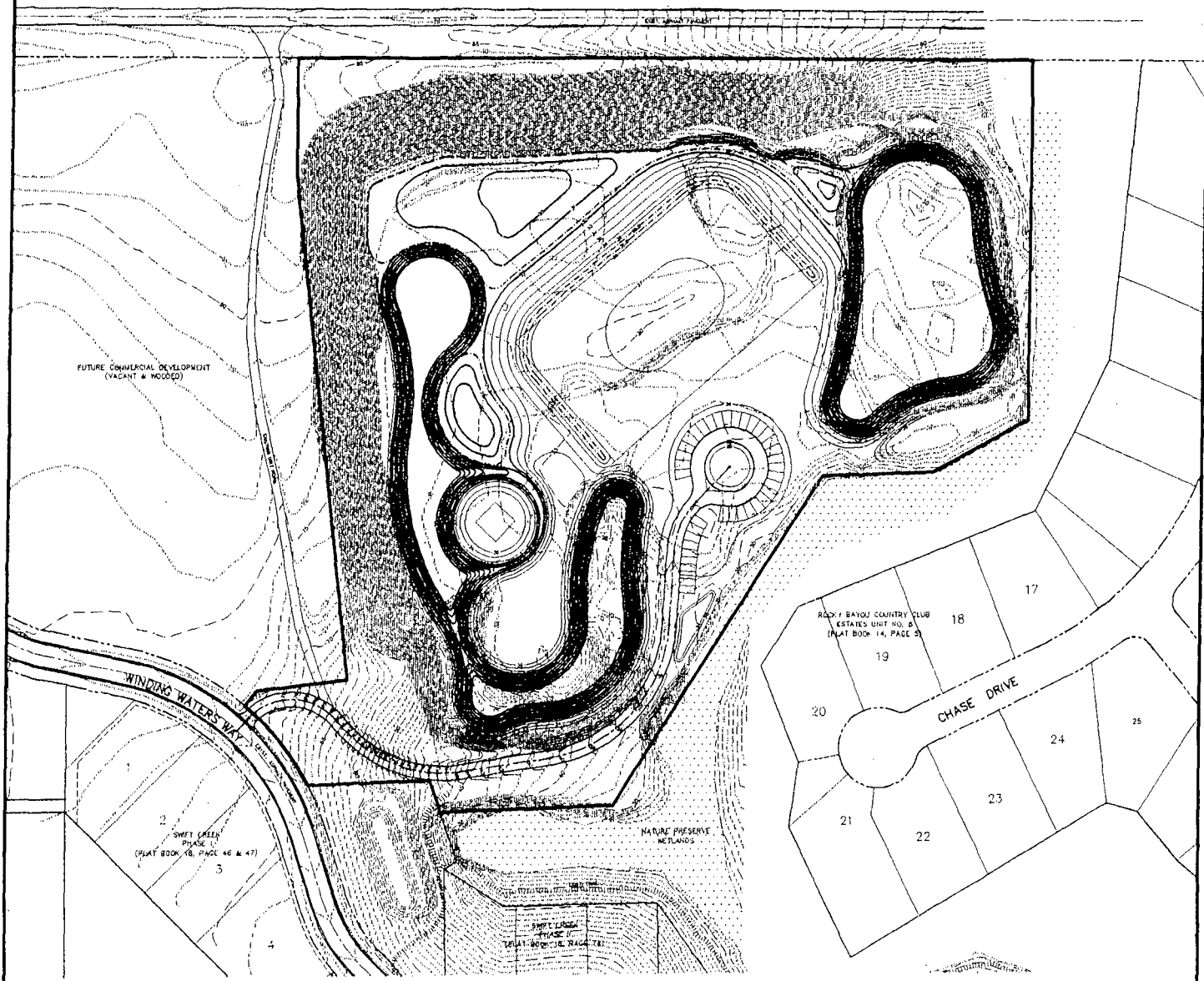

### GRADING PLAN

*James L. Burt*  
5/24/00

Applicant: RUCKEL PROPERTIES, INC.  
County: OKALOOSA  
Datum: N.G.V.D.  
Adjacent Property Owner's: SEE SHEET  
Water Body: STILL BRANCH

Purpose: CONSTRUCTION OF SITE IMPROVEMENTS  
RELATED TO NEW PARK.  
Original Work  Maintenance   
Sheet No. 4 of 13  
Date: May 9, 2000



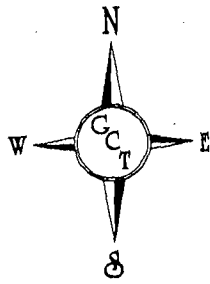

SCALE: 1" = 200'

### DREDGE & FILL TABLE

	AREA (S.F.)	ACREAGE	VOL. (C.Y.)
DREDGE	±42,794	±0.98	18,826
FILL	±60,224	±1.38	10,980

COLLEGE BLVD.

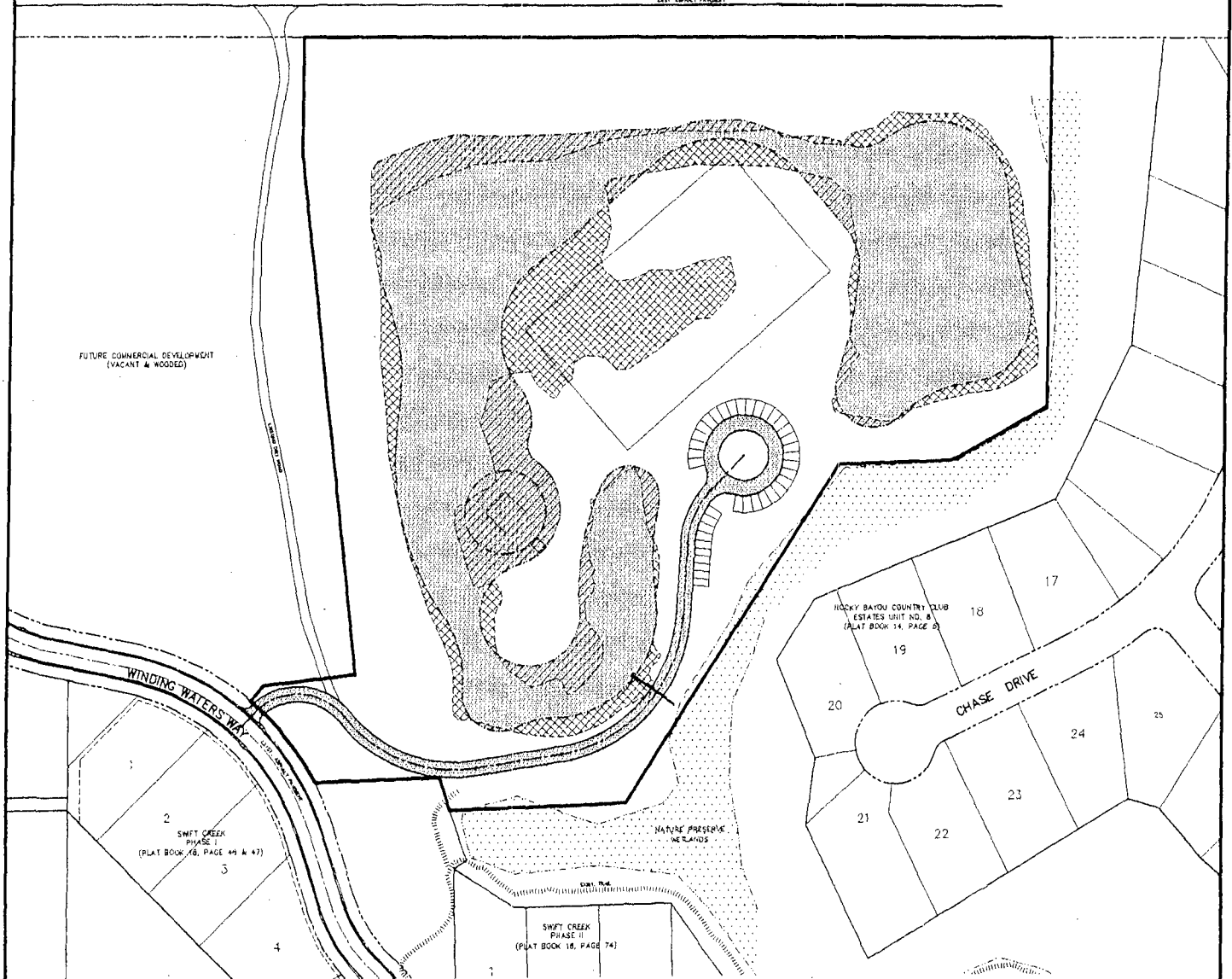

FUTURE COMMERCIAL DEVELOPMENT  
(VACANT & WOODED)

ROCKY BAYOU COUNTY CLUB  
ESTATES UNIT NO. 8  
(PLAT BOOK 14, PAGE 2)



WINDING WATERS WAY

CHASE DRIVE

2 SWIFT CREEK  
PHASE I  
(PLAT BOOK 42, PAGE 49 & 47)

SWIFT CREEK  
PHASE II  
(PLAT BOOK 16, PAGE 74)

NATURE PRESERVE  
WETLANDS

-  FILL AREA
-  DREDGE AREA



### DREDGE & FILL PLAN

*James L. Butler*  
5/24/00

Applicant: RUCKEL PROPERTIES, INC.  
 County: OKALOOSA  
 Datum: N.G.V.D.  
 Adjacent Property Owner's: SEE SHEET  
 Water Body: STILL BRANCH

Purpose: CONSTRUCTION OF SITE IMPROVEMENTS  
 RELATED TO NEW PARK.  
 Original Work  Maintenance   
 Sheet No. 5 of 13  
 Date: May 9, 2000

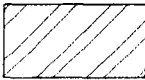
### MITIGATION PLANTING LEGEND

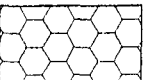

KEY	SCIENTIFIC NAME	QUANTITY	SIZE	SPACING
<b>33.00-31.50</b> 	<i>Sagittaria lancifolia</i>	0.50 AC = 2420	1 qt. / eq.	3' o.c.
<b>31.50-30.50</b> 	<i>Pontederia cordata</i>	0.44 AC = 2130	1 qt. / eq.	3' o.c.
<b>30.50-30.00</b> 	<i>Nymphaea odorata</i>	0.21 AC = 370	1 qt. / eq.	5' o.c.

  
 5/24/00

Applicant: RUCKEL PROPERTIES, INC.  
 County: OKALOOSA  
 Datum: N.G.V.D.  
 Adjacent Property Owner's: SEE SHEET  
 Water Body: STILL BRANCH

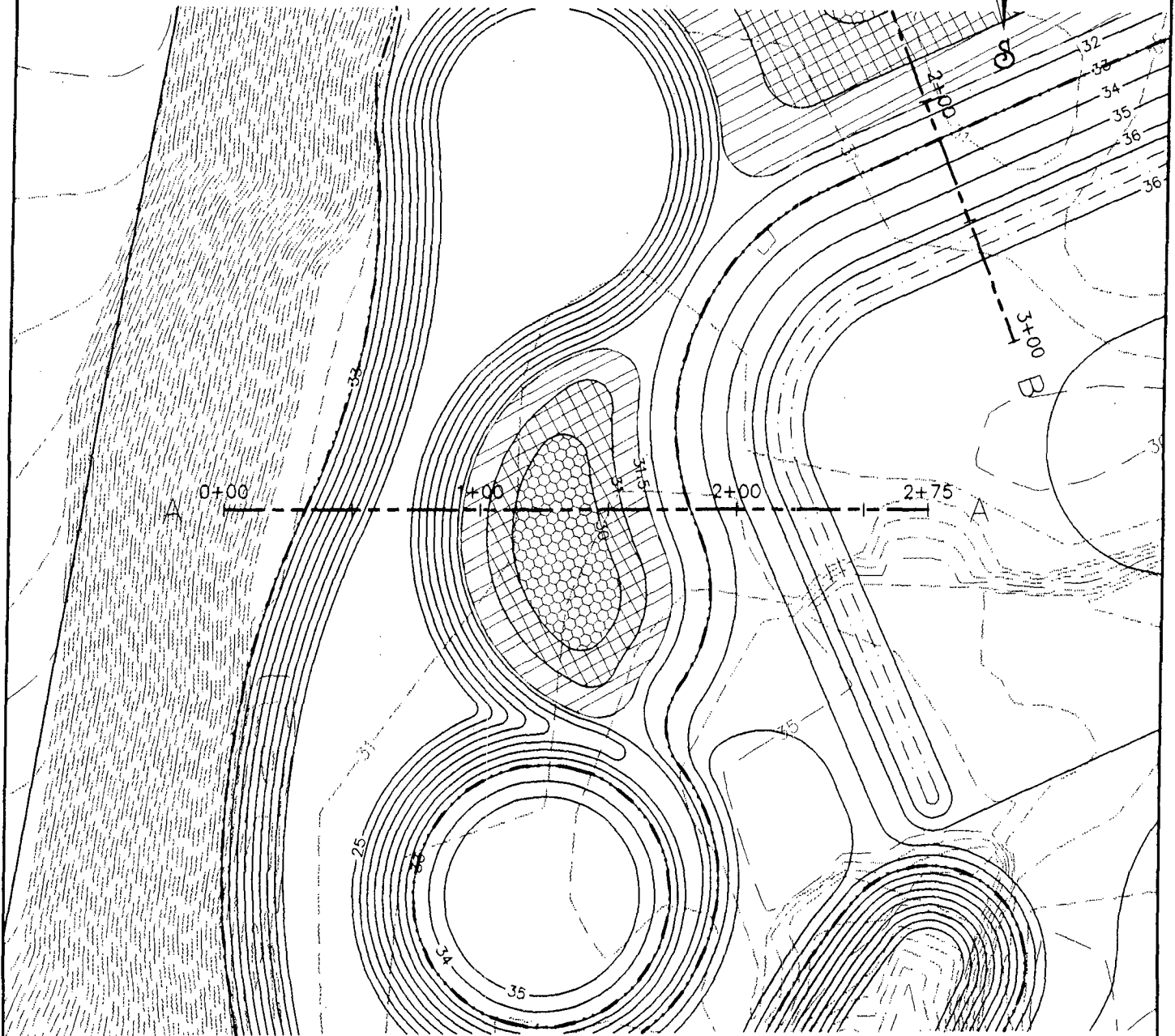
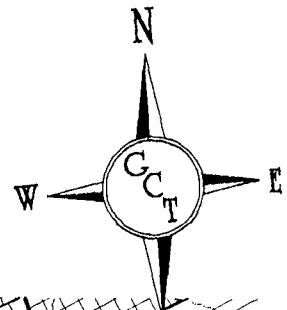
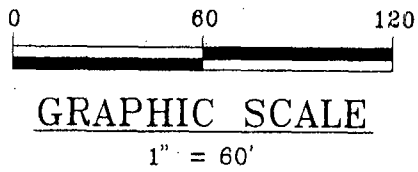
Purpose: CONSTRUCTION OF SITE IMPROVEMENTS  
 RELATED TO NEW PARK.  
 Original Work  Maintenance   
 Sheet No. 6 of 13  
 Date: May 9, 2000



-  NYMPHEA ODORATA
-  PONTEDERIA CORDATA

-  SAGITTARIA LANCIFOLIA

**SECTION A-A  
PLAN VIEW**

*James L. Boston*  
5/24/00

Applicant: RUCKEL PROPERTIES, INC.  
 County: OKALOOSA  
 Datum: N.G.V.D.  
 Adjacent Property Owner's: SEE SHEET  
 Water Body: STILL BRANCH

Purpose: CONSTRUCTION OF SITE IMPROVEMENTS  
 RELATED TO NEW PARK.  
 Original Work  Maintenance   
 Sheet No. 7 of 13  
 Date: May 9, 2000

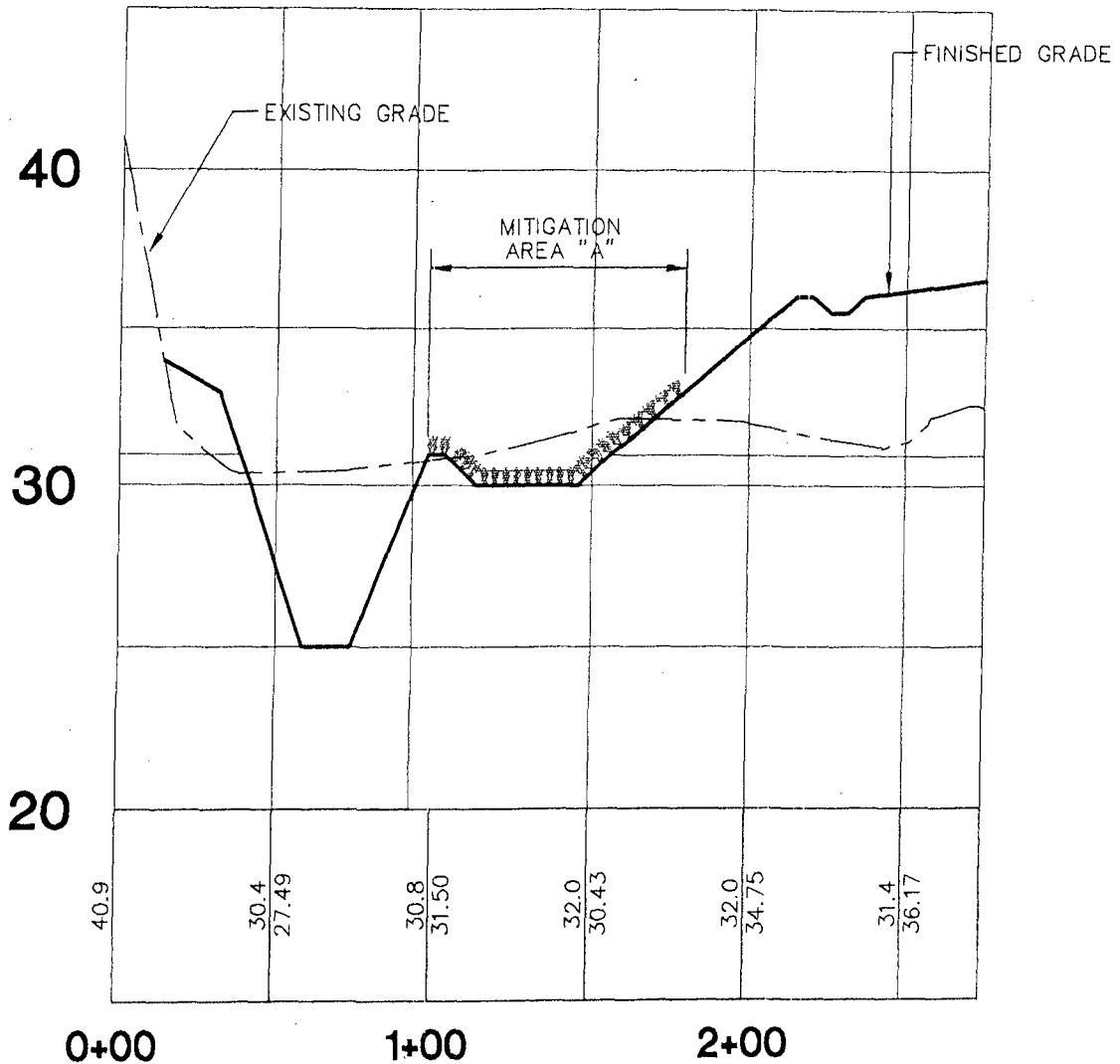

**SECTION A-A  
PROFILE**

*James L. Bant*  
5/24/00

SCALE: 1" = 60' HORIZONTAL 1" = 6' VERTICAL

Applicant: RUCKEL PROPERTIES, INC.  
 County: OKALOOSA  
 Datum: N.G.V.D.  
 Adjacent Property Owner's: SEE SHEET  
 Water Body: STILL BRANCH

Purpose: CONSTRUCTION OF SITE IMPROVEMENTS  
 RELATED TO NEW PARK.

Original Work  Maintenance

Sheet No. 8 of 13

Date: May 9, 2000

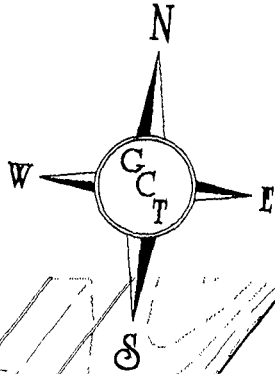

GRAPHIC SCALE

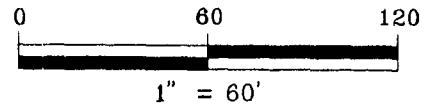

NYMPHEA ODORATA



PONTERDERIA CORDATA



SAGITTARIA LANCIFOLIA

SECTION B-B  
PLAN VIEW

*James L. Benton*  
5/24/00

Applicant: RUCKEL PROPERTIES, INC.  
County: OKALOOSA  
Datum: N.G.V.D.  
Adjacent Property Owner's: SEE SHEET  
Water Body: STILL BRANCH

Purpose: CONSTRUCTION OF SITE IMPROVEMENTS  
RELATED TO NEW PARK.  
Original Work  Maintenance   
Sheet No. 9 of 13  
Date: May 9, 2000

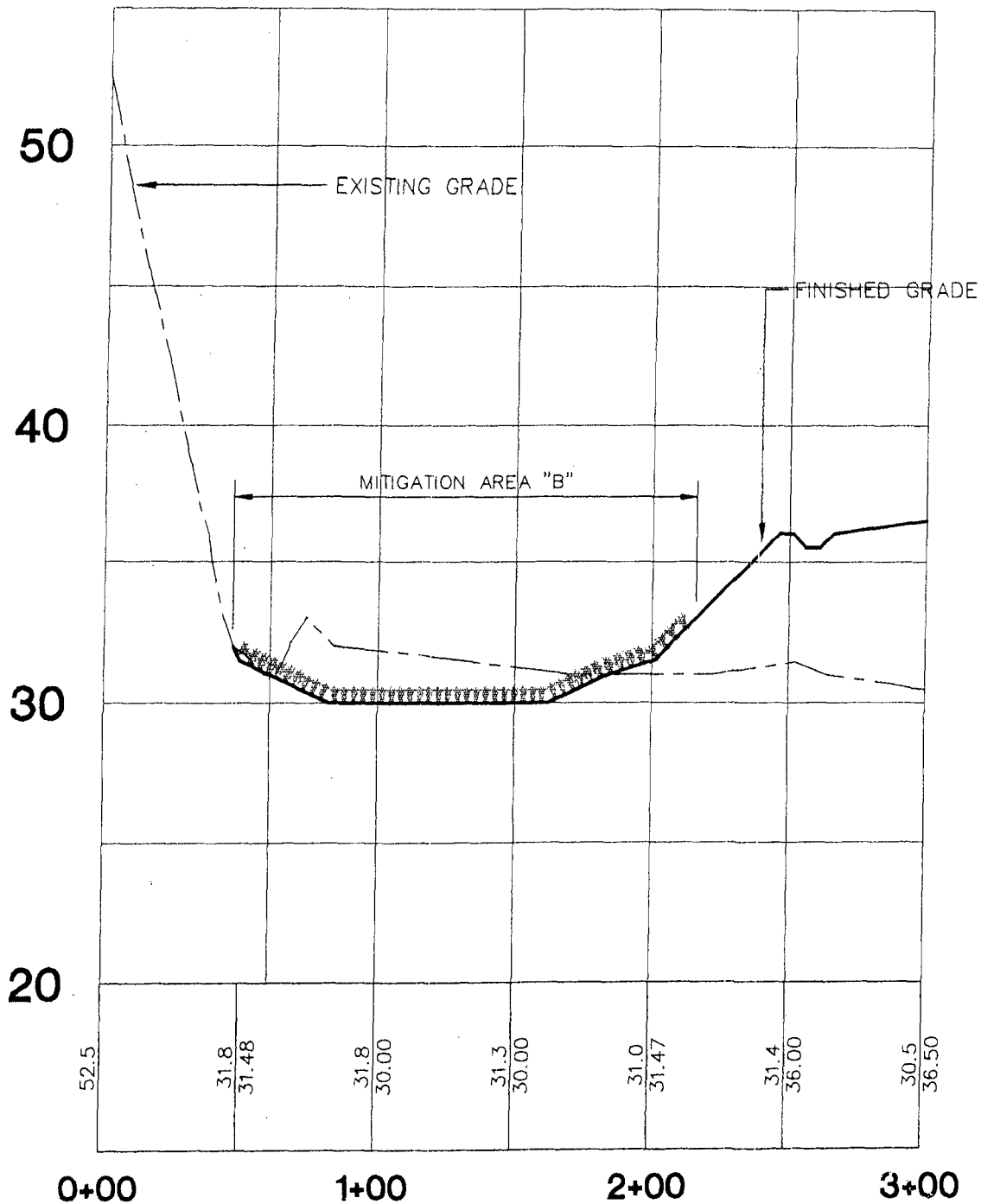

**SECTION B-B  
PROFILE**

*James L. Pate*  
5/24/00

SCALE: 1" = 60' HORIZONTAL 1" = 6' VERTICAL

Applicant: RUCKEL PROPERTIES, INC.  
 County: OKALOOSA  
 Datum: N.G.V.D.  
 Adjacent Property Owner's: SEE SHEET  
 Water Body: STILL BRANCH.

Purpose: CONSTRUCTION OF SITE IMPROVEMENTS  
 RELATED TO NEW PARK.  
 Original Work  Maintenance   
 Sheet No. 10 of 13  
 Date: May 9, 2000

0 60 120



GRAPHIC SCALE

1" = 60'

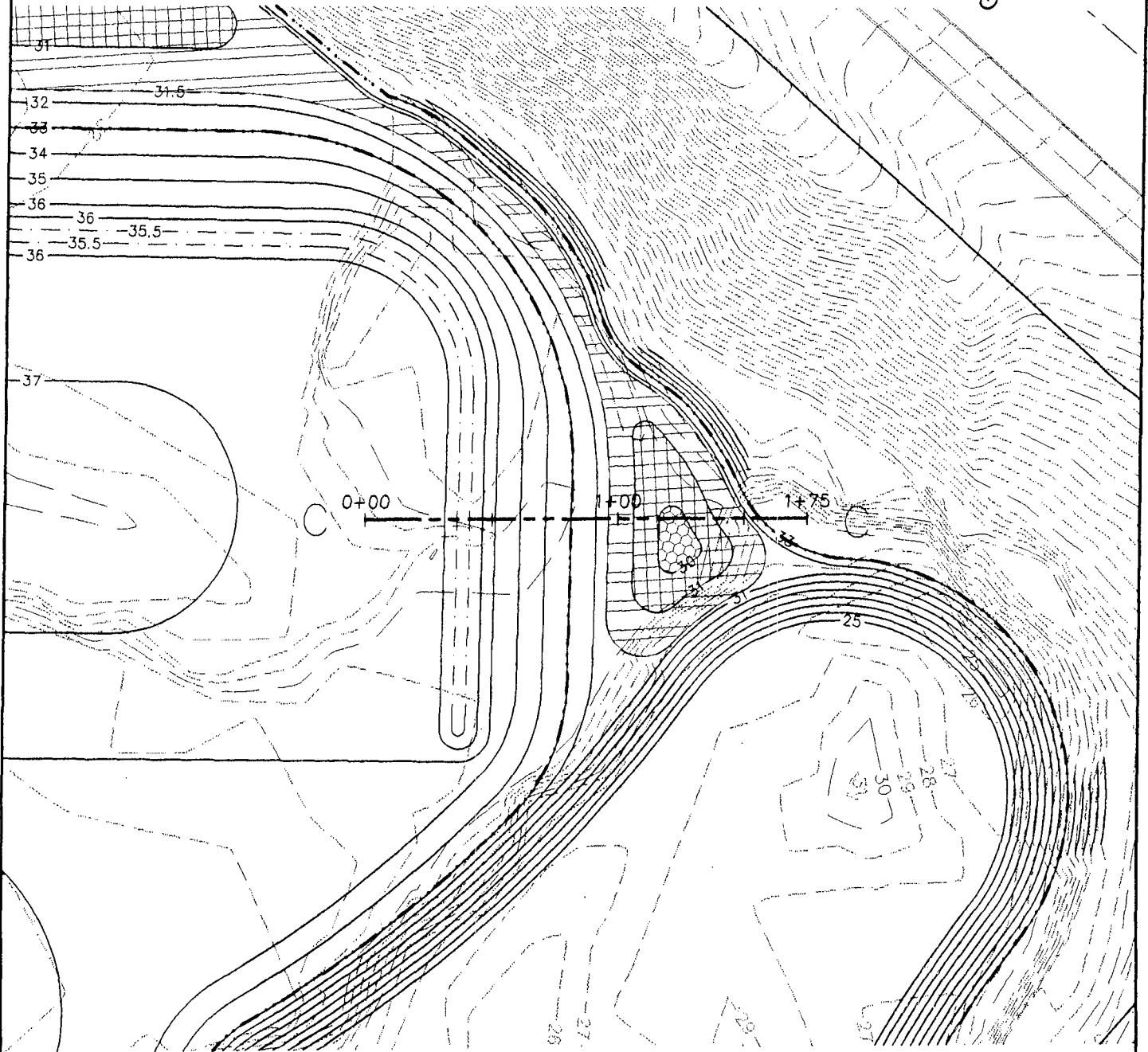
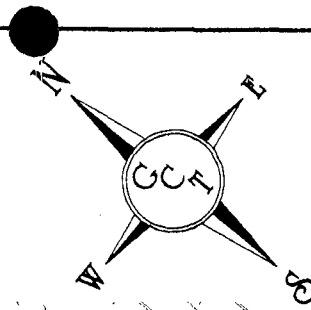

NYMPHEA ODORATA



PONTERDERIA CORDATA



SAGITTARIA LANCIFOLIA

SECTION C-C  
PLAN VIEW

*Jan L. Burt*  
5/24/00

Applicant: RUCKEL PROPERTIES, INC.

County: OKALOOSA

Datum: N.G.V.D.

Adjacent Property Owner's: SEE SHEET

Water Body: STILL BRANCH

Purpose: CONSTRUCTION OF SITE IMPROVEMENTS  
RELATED TO NEW PARK.

Original Work  Maintenance

Sheet No. 11 of 13

Date: May 9, 2000

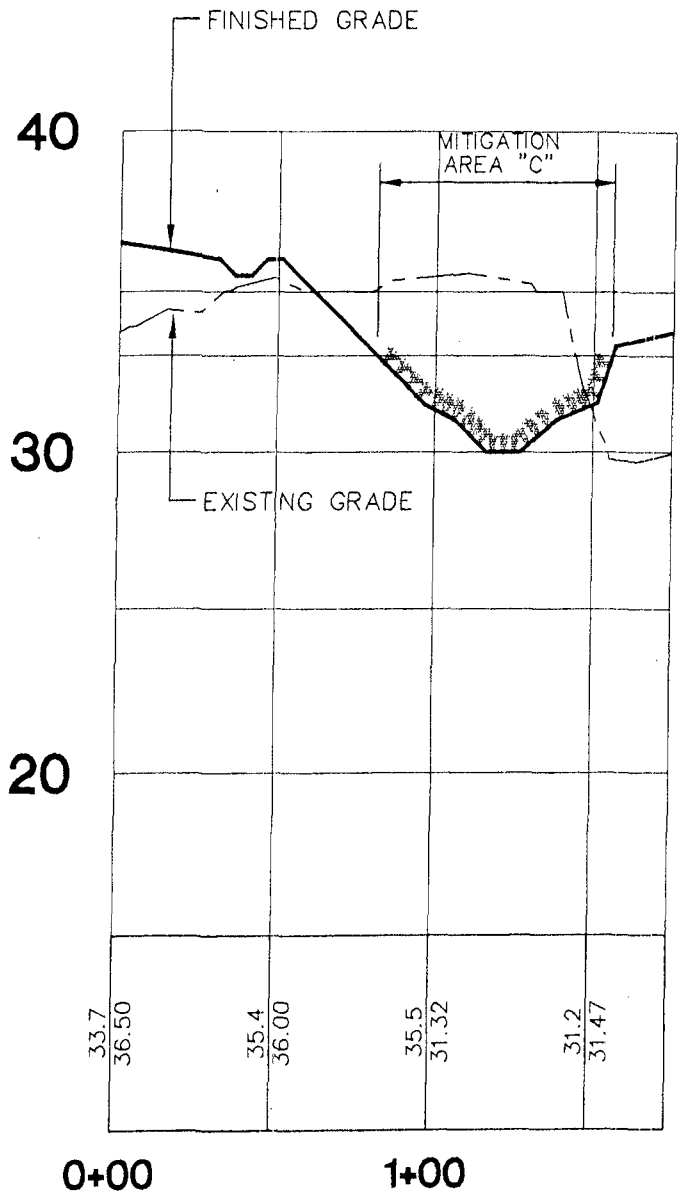

**SECTION C-C  
PROFILE**

*James L. Patten*  
5/24/00

SCALE: 1" = 60' HORIZONTAL 1" = 6' VERTICAL

Applicant: RUCKEL PROPERTIES, INC.  
 County: OKALOOSA  
 Datum: N.G.V.D.  
 Adjacent Property Owner's: SEE SHEET  
 Water Body: STILL BRANCH

Purpose: CONSTRUCTION OF SITE IMPROVEMENTS  
 RELATED TO NEW PARK.  
 Original Work  Maintenance   
 Sheet No. 12 of 13  
 Date: May 9, 2000



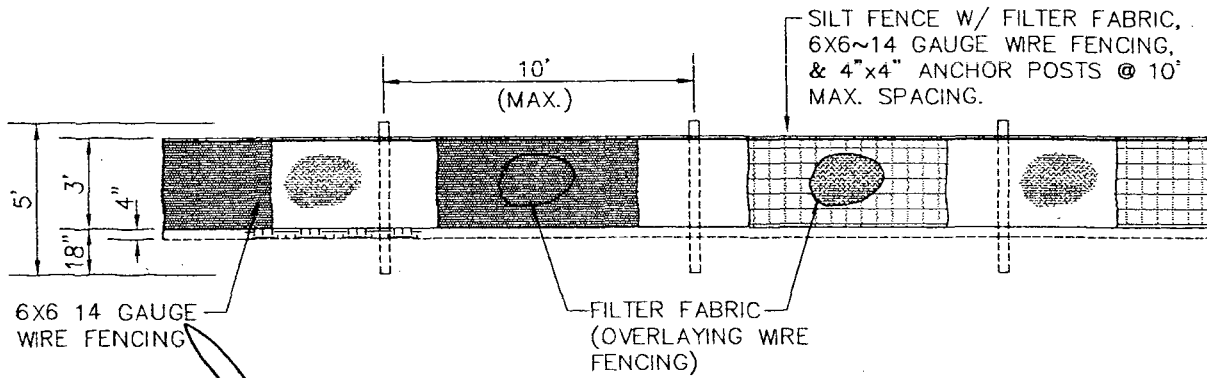
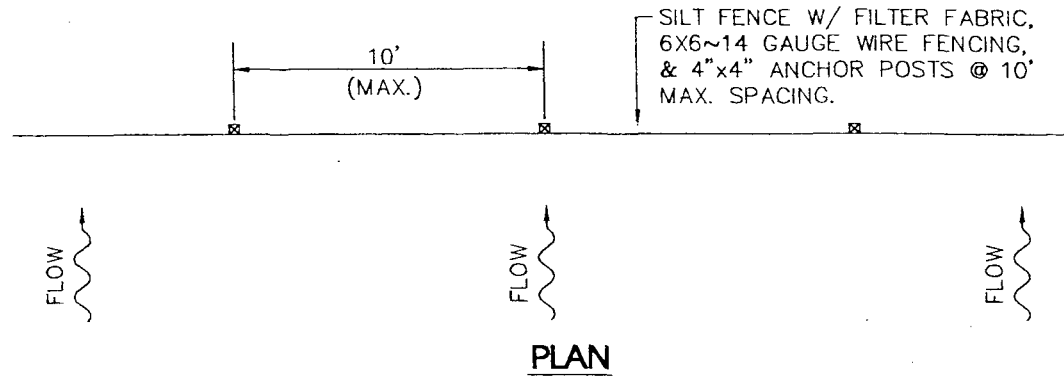

**CONSTRUCTION NOTE:**

1. INSTALL 4"x4" WOOD POSTS ALONG BARRIER LINE (10' MAX. SPACING, 18" MIN. EMBEDMENT). EXCAVATE 4" WIDE BY 4" DEEP TRENCH ALONG POST LINE, UPSLOPE OF BARRIER. FASTEN WIRE MESH FENCING TO 4"x4" POSTS WITH HEAVY DUTY WIRE STAPLES AT LEAST 1 INCH LONG, TIE WIRES OR HOG RINGS. STAPLE OR WIRE FILTER FABRIC TO UPSLOPE SIDE OF SUPPORT FENCING. EXTEND 8" OF FABRIC AND FENCING INTO TRENCH AND BACKFILL.
2. WHEN EXTRA STRENGTH FABRIC IS USED AND POSTS ARE SPACED 6 FEET INSTEAD OF 10 FEET APART, THE WIRE MESH SUPPORT FENCE MAY BE ELIMINATED. IN SUCH A CASE, THE FILTER FABRIC IS STAPLED OR WIRED DIRECTLY TO THE POSTS.

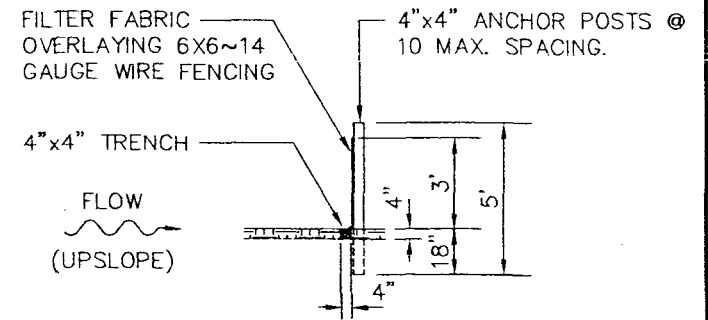

**EROSION CONTROL DETAIL**

N.T.S.

*Handwritten signature and date:*  
 5/24/00  
 [Signature]

Applicant: RUCKEL PROPERTIES, INC.  
 County: OKALOOSA  
 Datum: N.G.V.D.  
 Adjacent Property Owner's: SEE SHEET  
 Water Body: STILL BRANCH

Purpose: CONSTRUCTION OF SITE IMPROVEMENTS RELATED TO NEW PARK.  
 Original Work  Maintenance   
 Sheet No. 13 of 13  
 Date: May 9, 2000